

# Disc Harrows

DH1048, DH1060, DH1560, DH1572, DH1590, DH2572 & DH2596

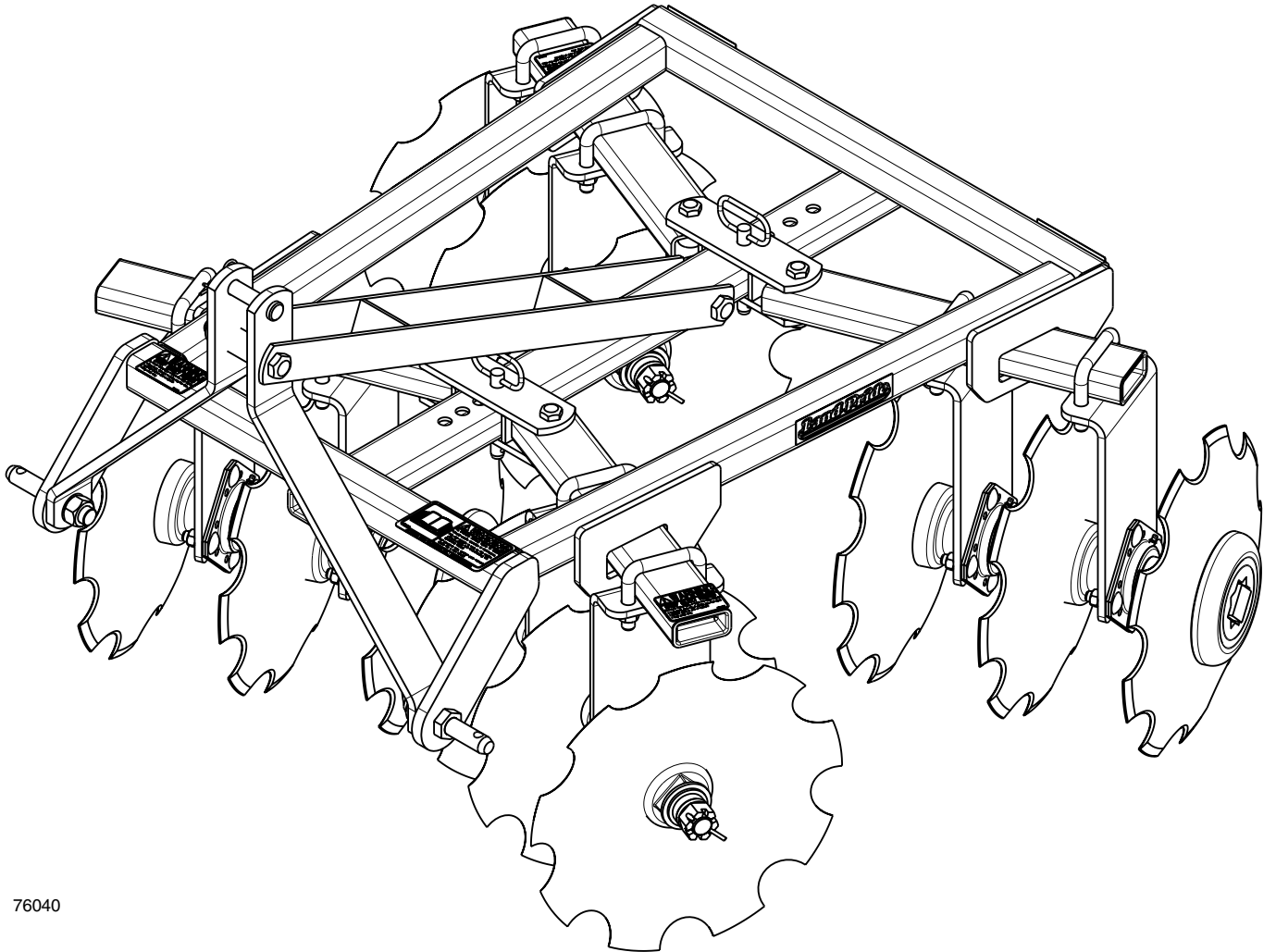

76040

## 322-013M Operator's Manual



Read the Operator's Manual entirely. When you see this symbol, the subsequent instructions and warnings are serious - follow without exception. Your life and the lives of others depend on it!

**Cover photo may show optional equipment not supplied with standard unit.**

**For an Operator's Manual and Decal Kit in French or Spanish Language, please see your Land Pride dealer.**



## Machine Identification

Record your machine details in the log below. If you replace this manual, be sure to transfer this information to the new manual.

If you, or the dealer, have added Options not originally ordered with the machine, or removed Options that were originally ordered, the weights and measurements are no longer accurate for your machine. Update the record by adding the machine weight and measurements provided in the Specifications & Capacities Section of this manual with the Option(s) weight and measurements.

<b>Model Number</b>	
<b>Serial Number</b>	
<b>Machine Height</b>	
<b>Machine Length</b>	
<b>Machine Width</b>	
<b>Machine Weight</b>	
<b>Delivery Date</b>	
<b>First Operation</b>	
<b>Accessories</b>	<hr/> <hr/> <hr/>

## Dealer Contact Information

**Name:** \_\_\_\_\_

**Street:** \_\_\_\_\_

**City/State:** \_\_\_\_\_

**Telephone:** \_\_\_\_\_

**Email:** \_\_\_\_\_

 <b>California Proposition 65</b> <b>WARNING:</b> Cancer and reproductive harm - <a href="http://www.P65Warnings.ca.gov">www.P65Warnings.ca.gov</a>
---



<b>Important Safety Information</b> . . . . .	<b>1</b>	<b>Section 6: Specifications &amp; Capacities</b> . . . . .	<b>22</b>
Safety at All Times . . . . .	1	<b>Section 7: Features &amp; Benefits</b> . . . . .	<b>25</b>
Look for the Safety Alert Symbol . . . . .	1	<b>Section 8: Troubleshooting</b> . . . . .	<b>27</b>
Safety Labels . . . . .	6	<b>Section 9: Torque Values Chart</b> . . . . .	<b>29</b>
<b>Introduction</b> . . . . .	<b>8</b>	<b>Section 10: Warranty</b> . . . . .	<b>30</b>
Application . . . . .	8		
Using This Manual . . . . .	8		
Owner Assistance . . . . .	8		
<b>Section 1: Assembly &amp; Set-Up</b> . . . . .	<b>10</b>		
Tractor Requirements . . . . .	10		
Torque Requirements . . . . .	10		
Dealer Assembly . . . . .	10		
DH10 & DH15 Series . . . . .	10		
DH25 Series . . . . .	11		
Optional Equipment . . . . .	12		
Scrapers			
DH15 & DH25 Series Only . . . . .	12		
Center Sweep			
DH15 & DH25 Series Only . . . . .	12		
Tractor Hook-Up . . . . .	13		
<b>Section 2: Operating Instructions</b> . . . . .	<b>14</b>		
Operator's Responsibilities . . . . .	14		
Transporting . . . . .	14		
Field Operation . . . . .	15		
General Operating Instructions . . . . .	15		
<b>Section 3: Adjustments</b> . . . . .	<b>16</b>		
Disc Angling . . . . .	16		
Disc Gang Lateral Adjustment . . . . .	17		
Front Disc Gangs on DH10 Series . . . . .	17		
Front Disc Gangs on DH15 Series . . . . .	17		
Front Disc Gangs on DH25 Series . . . . .	17		
Rear Disc Gangs on DH10 Series . . . . .	17		
Rear Disc Gangs on DH15 Series . . . . .	17		
Rear Disc Gangs on DH25 Series . . . . .	17		
Disc Leveling Front To Rear . . . . .	17		
Disc Blade Replacement . . . . .	17		
<b>Section 4: Accessories</b> . . . . .	<b>18</b>		
Electric Spin Spreader . . . . .	18		
Drag Harrow . . . . .	18		
Seed Bed Roller . . . . .	18		
Complete One Pass Seeding Application . . . . .	19		
<b>Section 5: Maintenance</b> . . . . .	<b>20</b>		
General Maintenance Information . . . . .	20		
Daily Operational Checks . . . . .	20		
Lubrication . . . . .	20		
Long-Term Storage . . . . .	20		
Lubrication Points . . . . .	21		



© Copyright 2021 All rights Reserved

Land Pride provides this publication "as is" without warranty of any kind, either expressed or implied. While every precaution has been taken in the preparation of this manual, Land Pride assumes no responsibility for errors or omissions. Neither is any liability assumed for damages resulting from the use of the information contained herein. Land Pride reserves the right to revise and improve its products as it sees fit. This publication describes the state of this product at the time of its publication, and may not reflect the product in the future.

Land Pride is a registered trademark.

All other brands and product names are trademarks or registered trademarks of their respective holders.

Printed in the United States of America.

See previous page for Table of contents.

### ***Manual QR Locator***

The QR (Quick Reference) codes below will take you to the Parts Manual. Download the appropriate App on your camera phone, open the App, point your phone on the QR code, and take a picture.



DH10 Series



DH15 & DH25 Series

### ***Dealer QR Locator***

The QR code below will link you to available dealers for Land Pride products.



Listed below are common practices that may or may not be applicable to the products described in this manual.

**Safety at All Times**

Careful operation is your best assurance against an accident.

All operators, no matter how much experience they may have, should carefully read this manual and other related manuals, or have the manuals read to them, before operating the power machine and this implement.

- ▲ Thoroughly read and understand the “Safety Label” section. Read all instructions noted on them.
- ▲ Do not operate the equipment while under the influence of drugs or alcohol as they impair the ability to safely and properly operate the equipment.
- ▲ The operator should be familiar with all functions of the tractor and attached implement, and be able to handle emergencies quickly.
- ▲ Make sure all guards and shields appropriate for the operation are in place and secured before operating the implement.
- ▲ Keep all bystanders away from equipment and work area.
- ▲ Start tractor from the driver’s seat with hydraulic controls in neutral.
- ▲ Operate tractor and controls from the driver’s seat only.
- ▲ Never dismount from a moving tractor or leave tractor unattended with engine running.
- ▲ Do not allow anyone to stand between tractor and implement while backing up to implement.
- ▲ Keep hands, feet, and clothing away from power-driven parts.
- ▲ While transporting and operating equipment, watch out for objects overhead and along side such as fences, trees, buildings, wires, etc.
- ▲ Do not turn tractor so tight as to cause hitched implement to ride up on the tractor’s rear wheel.
- ▲ Store implement in an area where children normally do not play. When needed, secure implement against falling with support blocks.



**Look for the Safety Alert Symbol**

The SAFETY ALERT SYMBOL indicates there is a potential hazard to personal safety involved and extra safety precaution must be taken. When you see this symbol, be alert and carefully read the message that follows it. In addition to design and configuration of equipment, hazard control, and accident prevention are dependent upon the awareness, concern, prudence, and proper training of personnel involved in the operation, transport, maintenance, and storage of equipment.

**Be Aware of Signal Words**

A signal word designates a degree or level of hazard seriousness. The signal words are:

**⚠ DANGER**

Indicates a hazardous situation that, if not avoided, will result in death or serious injury.

**⚠ WARNING**

Indicates a hazardous situation that, if not avoided, could result in death or serious injury.

**⚠ CAUTION**

Indicates a hazardous situation that, if not avoided, may result in minor or moderate injury.

**Safety Precautions for Children**

**Tragedy can occur if the operator is not alert to the presence of children, Children generally are attracted to implements and their work.**

- ▲ Never assume children will remain where you last saw them.
- ▲ Keep children out of the work area and under the watchful eye of a responsible adult.
- ▲ Be alert and shut the implement and tractor down if children enter the work area.
- ▲ Never carry children on the tractor or implement. There is not a safe place for them to ride. They may fall off and be run over or interfere with the control of the power machine.
- ▲ Never allow children to operate the power machine, even under adult supervision.
- ▲ Never allow children to play on the power machine or implement.
- ▲ Use extra caution when backing up. Before the tractor starts to move, look down and behind to make sure the area is clear.

**Tractor Shutdown & Storage**

- ▲ If engaged, disengage power take-off.
- ▲ Park on solid, level ground and lower implement to ground or onto support blocks.
- ▲ Put tractor in park or set park brake, turn off engine, and remove switch key to prevent unauthorized starting.
- ▲ Relieve all hydraulic pressure to auxiliary hydraulic lines.
- ▲ Wait for all components to stop before leaving operator’s seat.
- ▲ Use steps, grab-handles and anti-slip surfaces when stepping on and off the tractor.
- ▲ Detach and store implement in an area where children normally do not play. Secure implement using blocks and supports.

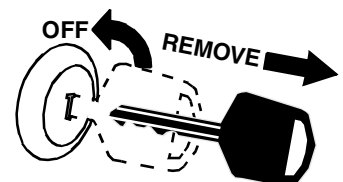

Listed below are common practices that may or may not be applicable to the products described in this manual.

### Use A Safety Chain

- ▲ A safety chain will help control drawn machinery should it separate from the tractor drawbar.
- ▲ Use a chain with the strength rating equal to or greater than the gross weight of the towed implement.
- ▲ Attach the chain to the tractor drawbar support or other specified anchor location. Allow only enough slack in the chain to permit turning.
- ▲ Always hitch the implement to the machine towing it. Do not use the safety chain to tow the implement.

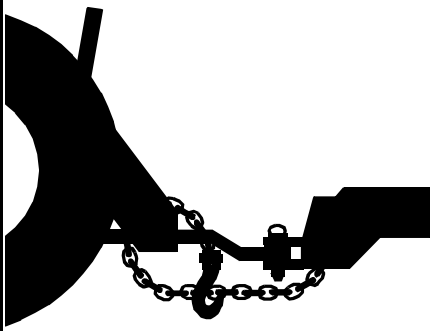

### Transport Safely

- ▲ Comply with federal, state, and local laws.
- ▲ Use towing vehicle and trailer of adequate size and capacity. Secure equipment towed on a trailer with tie downs and chains.
- ▲ Sudden braking can cause a towed trailer to swerve and upset. Reduce speed if towed trailer is not equipped with brakes.
- ▲ Avoid contact with any over head utility lines or electrically charged conductors.
- ▲ Always drive with load on end of loader arms low to the ground.
- ▲ Always drive straight up and down steep inclines with heavy end of a tractor with loader attachment on the "uphill" side.
- ▲ Engage park brake when stopped on an incline.
- ▲ Maximum transport speed for an attached equipment is 20 mph. **DO NOT EXCEED.** Never travel at a speed which does not allow adequate control of steering and stopping. Some rough terrains require a slower speed.
- ▲ As a guideline, use the following maximum speed weight ratios for attached equipment:
  - 20 mph** when weight of attached equipment is less than or equal to the weight of machine towing the equipment.
  - 10 mph** when weight of attached equipment exceeds weight of machine towing equipment but not more than double the weight.
- ▲ **IMPORTANT:** Do not tow a load that is more than double the weight of the vehicle towing the load.

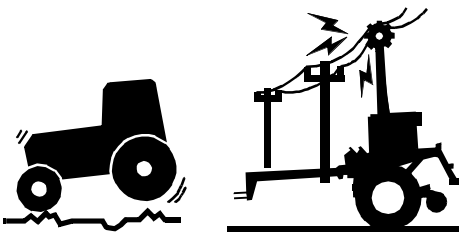

### Tire Safety

- ▲ Tire changing can be dangerous and must be performed by trained personnel using the correct tools and equipment.
- ▲ Always properly match the wheel size to the properly sized tire.
- ▲ Always maintain correct tire pressure. Do not inflate tires above recommended pressures shown in the Operator's Manual.
- ▲ When inflating tires, use a clip-on chuck and extension hose long enough to allow you to stand to one side and NOT in front of or over the tire assembly. Use a safety cage if available.
- ▲ Securely support the implement when changing a wheel.
- ▲ When removing and installing wheels, use wheel handling equipment adequate for the weight involved.
- ▲ Make sure wheel bolts have been tightened to the specified torque.



### Practice Safe Maintenance

- ▲ Understand procedure before doing work. Refer to the Operator's Manual for additional information.
- ▲ Work on a level surface in a clean dry area that is well-lit.
- ▲ Lower implement to the ground and follow all shutdown procedures before leaving the operator's seat to perform maintenance.
- ▲ Do not work under any hydraulic supported equipment. It can settle, suddenly leak down, or be lowered accidentally. If it is necessary to work under the equipment, securely support it with stands or suitable blocking beforehand.
- ▲ Use properly grounded electrical outlets and tools.
- ▲ Use correct tools and equipment for the job that are in good condition.
- ▲ Allow equipment to cool before working on it.
- ▲ Disconnect battery ground cable (-) before servicing or adjusting electrical systems or before welding on implement.
- ▲ Inspect all parts. Make certain parts are in good condition & installed properly.
- ▲ Replace parts on this implement with genuine Land Pride parts only. Do not alter this implement in a way which will adversely affect its performance.
- ▲ Do not grease or oil implement while it is in operation.
- ▲ Remove buildup of grease, oil, or debris.
- ▲ Always make sure any material and waste products from the repair and maintenance of the implement are properly collected and disposed.
- ▲ Remove all tools and unused parts from equipment before operation.
- ▲ Do not weld or torch on galvanized metal as it will release toxic fumes.



Listed below are common practices that may or may not be applicable to the products described in this manual.

### Prepare for Emergencies

- ▲ Be prepared if a fire starts.
- ▲ Keep a first aid kit and fire extinguisher handy.
- ▲ Keep emergency numbers for doctor, ambulance, hospital, and fire department near the phone.

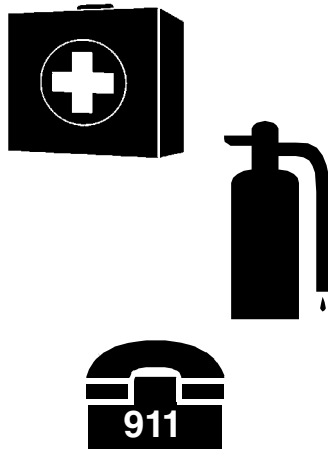

### Wear Personal Protective Equipment (PPE)

- ▲ Wear protective clothing and equipment appropriate for the job such as safety shoes, safety glasses, hard hat, and ear plugs.
- ▲ Clothing should fit snug without fringes and pull strings to avoid entanglement with moving parts.
- ▲ Prolonged exposure to loud noise can cause hearing impairment or hearing loss. Wear suitable hearing protection such as earmuffs or earplugs.
- ▲ Operating equipment safely requires the operator's full attention. Avoid wearing headphones while operating equipment.



### Avoid High Pressure Fluids

- ▲ Escaping fluid under pressure can penetrate the skin causing serious injury.
- ▲ Relieve all residual pressure before disconnecting hydraulic lines or performing work on the hydraulic system.
- ▲ Make sure all hydraulic fluid connections are properly tightened/torqued and all hydraulic hoses and lines are in good condition before applying pressure to the system.
- ▲ Use a piece of paper or cardboard, NOT BODY PARTS, to check for suspected leaks.
- ▲ Wear protective gloves and safety glasses or goggles when working with hydraulic systems.
- ▲ **DO NOT DELAY.** If an accident occurs, see a doctor familiar with this type of injury immediately. Any fluid injected into the skin or eyes must be treated within a few hours or gangrene may result.



### Use Safety Lights and Devices

- ▲ Slow moving tractors, and self-propelled equipment can create a hazard when driven on public roads. They are difficult to see, especially at night. Use the Slow Moving Vehicle (SMV) sign when on public roads.
- ▲ Flashing warning lights and turn signals are recommended whenever driving on public roads.

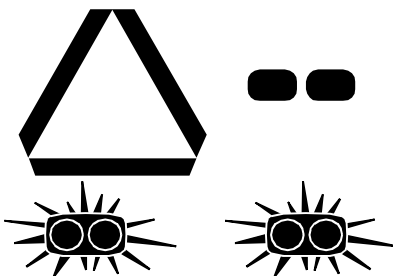

### Use Seat Belt and ROPS

- ▲ Land Pride recommends the use of a CAB or roll-over-protective-structures (ROPS) and seat belt in almost all power machines. Combination of a CAB or ROPS and seat belt will reduce the risk of serious injury or death if the power machine should be upset.
- ▲ If ROPS is in the locked-up position, fasten seat belt snugly and securely to help protect against serious injury or death from falling and machine overturn.

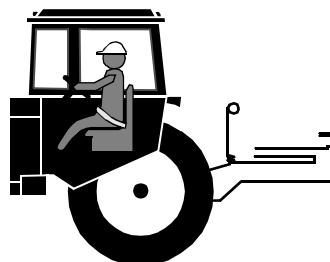

### Keep Riders Off Machinery

- ▲ Never carry riders on the tractor or implement.
- ▲ Riders obstruct operator's view and interfere with the control of the power machine.
- ▲ Riders can be struck by objects or thrown from the equipment.
- ▲ Never use tractor or implement to lift or transport riders.

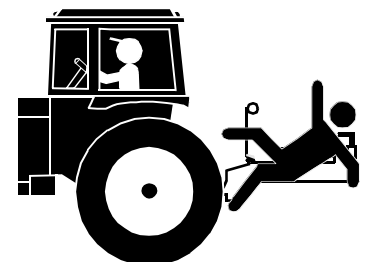

Listed below are common practices that may or may not be applicable to the products described in this manual.

### Avoid crystalline Silica (quartz) Dust

Because crystalline silica is a basic component of sand and granite, many activities at construction sites produce dust containing crystalline silica. Trenching, sawing, and boring of material containing crystalline silica can produce dust containing crystalline silica particles. This dust can cause serious injury to the lungs (silicosis).

There are guidelines which should be followed if crystalline silica (quartz) is present in the dust.



- ▲ Be aware of and follow OSHA (or other local, State, or Federal) guidelines for exposure to airborne crystalline silica.
- ▲ Know the work operations where exposure to crystalline silica may occur.
- ▲ Participate in air monitoring or training programs offered by the employer.
- ▲ Be aware of and use optional equipment controls such as water sprays, local exhaust ventilation, and enclosed cabs with positive pressure air conditioning if the machine has such equipment. Otherwise respirators shall be worn.
- ▲ Where respirators are required, wear a respirator approved for protection against crystalline silica containing dust. Do not alter respirator in any way. Workers who use tight-fitting respirators can not have beards/mustaches which interfere with the respirator seal to the face.
- ▲ If possible, change into disposable or washable work clothes at the work site; shower and change into clean clothing before leaving the work site.
- ▲ Do not eat, drink, use tobacco products, or apply cosmetics in areas where there is dust containing crystalline silica.
- ▲ Store food, drink, and personal belongings away from the work area.
- ▲ Wash hands and face before eating, drinking, smoking, or applying cosmetics after leaving the exposure area.

### Handle Chemicals Properly

- ▲ Protective clothing should be worn.
- ▲ Handle all chemicals with care.
- ▲ Follow instructions on container label.
- ▲ Agricultural chemicals can be dangerous. Improper use can seriously injure persons, animals, plants, soil, and property.
- ▲ Inhaling smoke from any type of chemical fire can be a serious health hazard.
- ▲ Store or dispose of unused chemicals as specified by the chemical manufacturer.



### Dig Safe - Avoid Underground Utilities

- ▲ **USA: Call 811**  
**CAN: [digsafecanada.ca](http://digsafecanada.ca)**  
Always contact your local utility companies (electrical, telephone, gas, water, sewer, and others) before digging so that they may mark the location of any underground services in the area.
- ▲ Be sure to ask how close you can work to the marks they positioned.







---

This page left blank intentionally.



## Important Safety Information

### Safety Labels

Your Disc Harrow comes equipped with all safety labels in place. They were designed to help you safely operate your equipment. Read and follow their directions.

1. Keep all safety labels clean and legible.
2. Refer to this section for proper label placement. Replace all damaged or missing labels. Order new labels from your nearest Land Pride dealer. To find your nearest dealer, visit our dealer locator at [www.landpride.com](http://www.landpride.com).
3. Some new equipment installed during repair requires safety labels to be affixed to the replaced component as

specified by Land Pride. When ordering new components make sure the correct safety labels are included in the request.

4. Refer to this section for proper label placement. To install new labels:
  - a. Clean surface area where label is to be placed.
  - b. Spray soapy water onto the cleaned area.
  - c. Peel backing from label and press label firmly onto the surface.
  - d. Squeeze out air bubbles with edge of a credit card or with a similar type of straight edge.

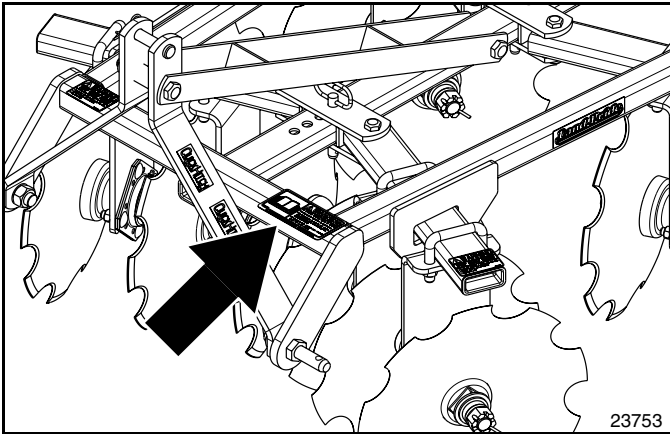

**DH10 Series**

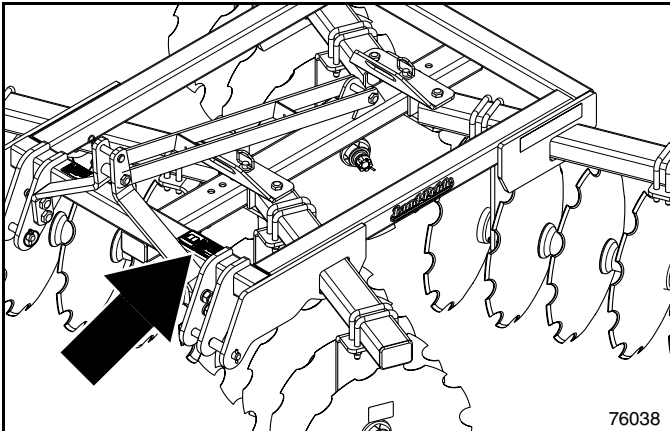

**DH15 & DH25 Series**

	<b>⚠ WARNING</b>
	<p>To Prevent Serious Injury or Death:</p> <ul style="list-style-type: none"> <li>Avoid unsafe operation or maintenance.</li> <li>Do Not operate or work on this machine without reading and understanding the Operator's Manual.</li> <li>If manual is lost, contact your nearest dealer for a new manual.</li> </ul>

838-293C

⚠ WARNING: Cancer and reproductive harm - [www.P65Warnings.ca.gov](http://www.P65Warnings.ca.gov)

**838-293C**

Warning: To Prevent Serious Injury or Death

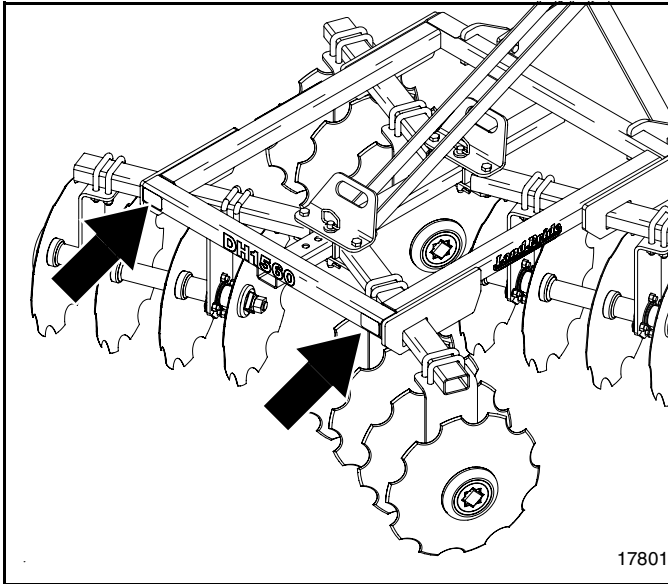

**838-614C**

2" x 9" Red Reflector (DH1590 & DH2596)



**858-095C**

2" x 4 1/2" Red Reflector (DH1048, DH1060, DH1560, DH1572, & DH2572)

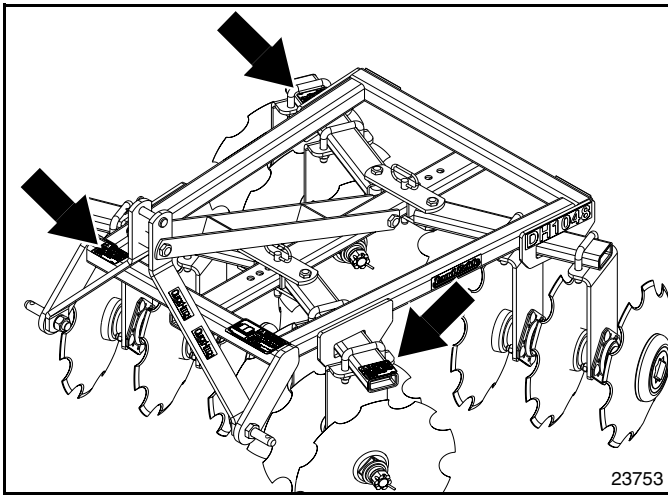

DH10 & DH15 Series

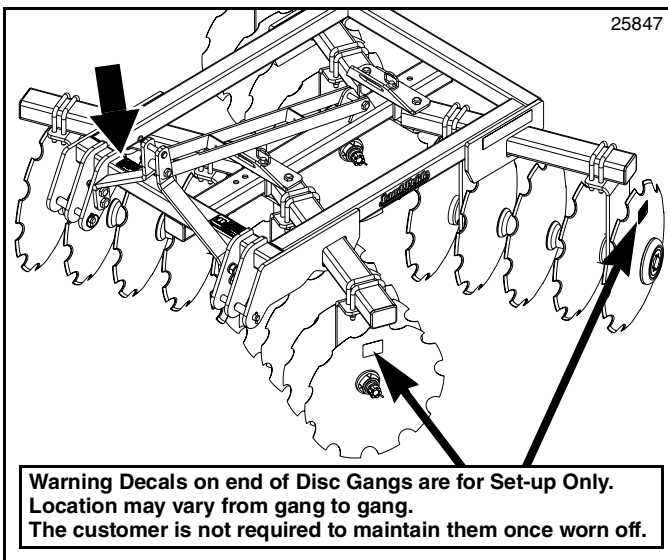

Warning Decals on end of Disc Gangs are for Set-up Only. Location may vary from gang to gang. The customer is not required to maintain them once worn off.

DH25 Series

**! WARNING**

**SHARP OBJECT HAZARD**

To Prevent Serious Injury or Death from Sharp Objects:

- Keep hands, feet, hair, & clothing away from discs.
- DO NOT stand or climb on implement.
- Keep others away.

838-093C

**838-093C**

Warning: Sharp Object Hazard



## Introduction

Land Pride welcomes you to the growing family of new product owners. This Disc Harrow has been designed with care and built by skilled workers using quality materials. Proper assembly, maintenance, and safe operating practices will help you get years of satisfactory use from this machine.

## Application

The **DH10 Series Economy Disc Harrows** are designed to open up and break up the soil surface and to prepare the soil for seedbed or planting preparation. The DH10 Series Discs are adapted for Category 1 three-point hitch mounting on tractors in the 20-40 horsepower range, and are Quick Hitch adaptable. The forward gang has aggressive notched discs while the rear gang has a choice of notched or smooth discs to quickly break up and evenly redistribute the finely cultivated topsoil. The DH10 Series Land Pride Disc Harrows have applications in homeowner landscaping, smaller nurseries, gardens, smaller hobby farms, and wild game food plots. The 48" Disc Harrow features 16" disks, while the 60" offers 16" or 18".

The **DH15 Series Disc Harrows** are designed to breakup and redistribute the soil surface in preparation of seedbeds for planting operations. The DH15 Series Discs are adapted for Category 1 three-point hitch on tractors in the 25-65 horsepower range, and are Quick Hitch adaptable. Disc gangs can be ordered with smooth or notched disc gang arrays for lighter or more aggressive applications based on customer needs. The DH15 Series Disc Harrows have applications in commercial landscaping, nurseries, large gardens, farms, and municipal beautification programs.

The **DH25 Series Disc Harrows** are designed to breakup and redistribute the soil surface in preparation of seedbed and field planting operations. The DH25 Series Discs are adapted for category 1 and 2 three-point hitch on tractors in the 35-100 horsepower range, and are Quick Hitch adaptable. Disc gangs can be ordered with smooth or notched disc gang arrays for lighter or more aggressive applications and this series does offer 20" diameter or larger 22" diameter discs to meet specific customer needs. The DH25 Series Disc Harrows have applications in commercial landscaping, construction, farms, ranches, and municipal maintenance programs.

See "**Specifications & Capacities**" on page 22 and "**Features & Benefits**" on page 25 for additional information and performance enhancing options.

## Using This Manual

- This Operator's Manual is designed to help familiarize the operator with safety, assembly, operation, adjustments, troubleshooting, and maintenance. Read this manual and follow the recommendations to help ensure safe and efficient operation.
- The information contained within this manual was current at the time of printing. Some parts may change slightly to assure you of the best performance.
- To order a new Operator's or Parts Manual, contact your authorized dealer. Manuals can also be downloaded, free-of-charge, from our website at [www.landpride.com](http://www.landpride.com)

## Terminology

"Right" or "Left" as used in this manual is determined by facing forward in the direction the machine will operate while in use unless otherwise stated.

## Definitions

**IMPORTANT:** A special point of information related to the following topic. Land Pride's intention is this information must be read & noted before continuing.

**NOTE:** A special point of information that the operator should be aware of before continuing.

## Owner Assistance

The dealer should complete the Online Warranty Registration at the time of purchase. This information is necessary to provide you with quality customer service.

The parts on your Disc Harrow have been specially designed by Land Pride and should only be replaced with genuine Land Pride parts. Contact a Land Pride dealer if customer service or repair parts are required. Your Land Pride dealer has trained personnel, repair parts, and equipment needed to service the implement.

## Introduction

### Serial Number

For quick reference and prompt service, record model and serial number on the inside cover page and again on the warranty page. Always provide model number and serial number when ordering parts and in all correspondences with your Land Pride dealer. For location of your serial number plate, see Figure 1.

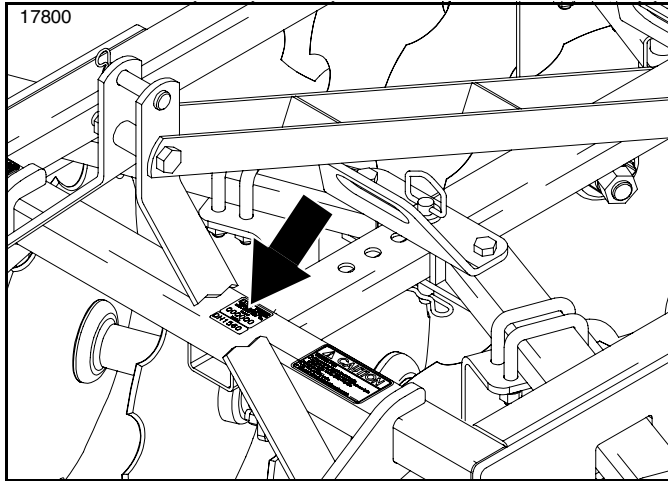

**Serial Number Plate Location**  
**Figure 1**

### Further Assistance

Your dealer wants you to be satisfied with your new Disc Harrow. If for any reason you do not understand any part of this manual or are not satisfied with the service received, the following actions are suggested:

1. Discuss any problems you have with your implement with your dealership service personnel so they can address the problem.
2. If you are still not satisfied, seek out the owner or general manager of the dealership, explain the question/problem, and request assistance.
3. For further assistance write to:

**Land Pride Service Department**  
**1525 East North Street**

P.O. Box 5060  
Salina, Ks. 67402-5060

E-mail address  
lpservicedept@landpride.com



## Section 1: Assembly & Set-Up

### Tractor Requirements

Tractor 3-Point hitch Category and horsepower should match your Disc Harrow Series.

- DH10 Series  
3-Point Hitch . . . . . Category 1  
Horsepower . . . . . 20-40 horsepower
- DH15 Series  
3-Point Hitch . . . . . Category 1  
Horsepower . . . . . 25-65 horsepower
- DH25 Series  
3-Point Hitch . . . . . Category 1 & 2  
Horsepower . . . . . 35-100 horsepower

### WARNING

*To avoid serious injury or death:*

*Lightweight tractors with rear attached implements may need weights added to the front to maintain steering control. Consult your tractor Operator's Manual to determine proper weight requirements and maximum weight limitations.*

### Torque Requirements

Refer to “**Torque Values Chart**” on page 29 to determine correct torque values for common bolts. See “**Additional Torque Values**” at bottom of chart for exceptions to standard torque values.

### Dealer Assembly DH10 & DH15 Series

### WARNING

*To avoid serious injury or death:*

*Be careful when working with disc blades as the edges are sharp. Wear gloves when working around disc blades. Keep others away.*

#### Refer to Figure 1-1

1. Unpack Disc Harrow from shipping crate.
2. Attach 3-Point straps (#1 & #2) to front lower lifting lugs using 7/8" hitch pins (#3), lock washers (#4), and 7/8" -14 hex nuts (#5). **Do not tighten.**
3. Attach 3-Point brace (#6) to the harrow's center beam with 3/4" -10 x 4 1/2" GR5 hex head cap screw (#7) and 3/4" locknut (#8). **Do not tighten.**
4. Insert 3/4" -10 x 4 1/2" hex head bolt (#9) through the left side of 3-Point brace (#6), left 3-Point strap (#1), spacer (#10), right 3-Point strap (#2), and right side of 3-Point brace (#6). Secure bolt with 3/4" lock nut (#5). **Do not tighten.**
5. Insert 3/4" clevis pin (#12) through upper holes in 3-Point straps (#1 & #2). Secure clevis pin with hairpin cotter (#13).
6. Tighten all attaching hardware to the correct torque.

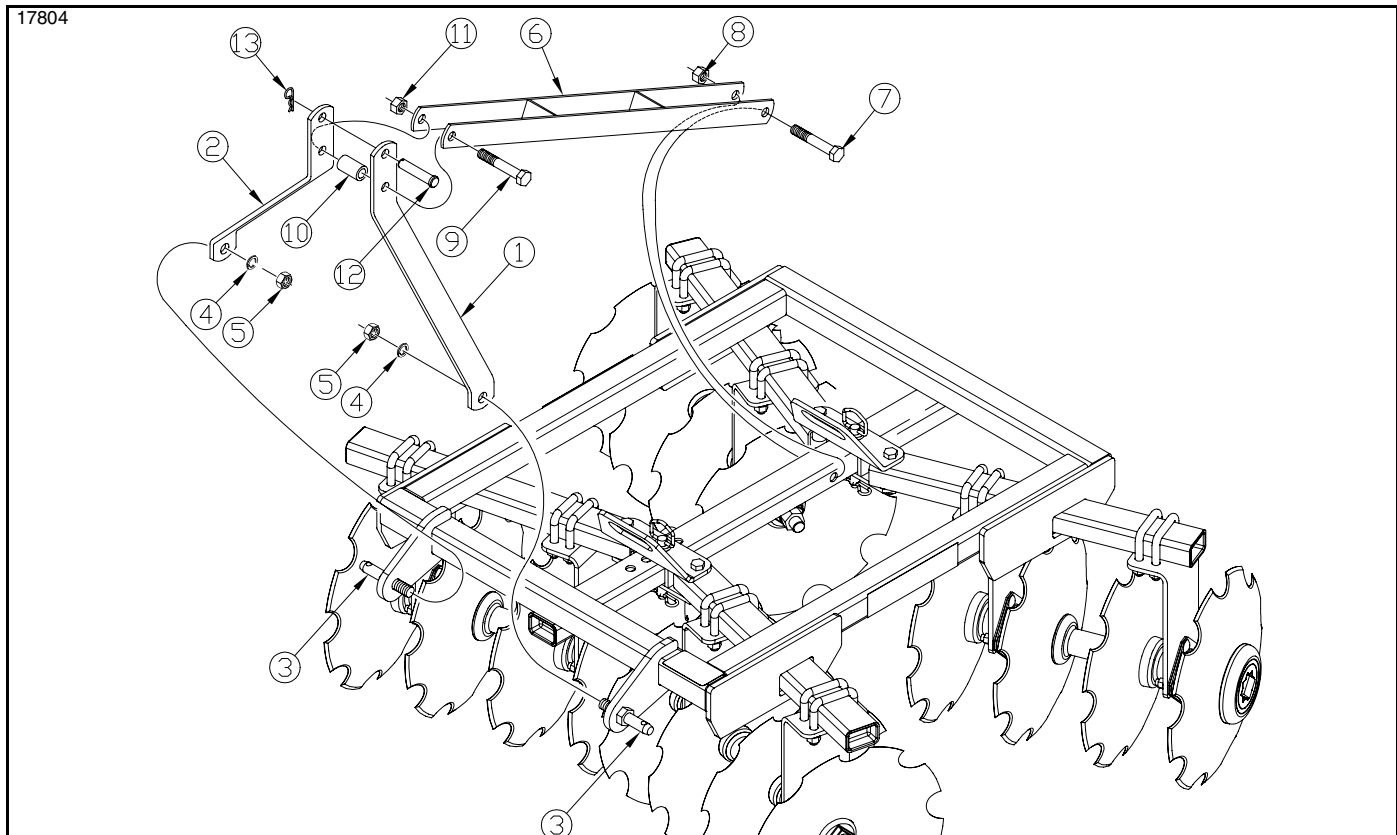

**Dealer Assembly (DH1560 Shown)  
Figure 1-1**

## Section 1: Assembly & Set-Up

### DH25 Series

Refer to Figure 1-2:



### WARNING

To avoid serious injury or death:

Be careful when working with disc blades as the edges are sharp. Wear gloves when working around disc blades. Keep others away.

1. Unpack Disc Harrow from shipping crate.
2. Assemble 3-Point hitch as shown in Figure 1-2.
  - a. Align upper straps (#3) and rear brace (#8) as shown.
  - b. Place spacer (#1) between upper straps (#3). Secure spacer with 3/4"-10 x 5" GR5 bolt (#10) and locknut (#12).
3. Remove bolts (#10), locknuts (#12), spacers (#2), and bottom brackets (#4).

4. Insert swing arms (#6) through slots in mainframe (#7). Re-install 3/4"-10 x 5" GR5 bolts (#10), locknuts (#12), spacers (#2), and bottom brackets (#4) as shown.

**IMPORTANT:** The next procedure will require lifting mainframe frame (#7). A forklift or adequate lifting device is recommended.

5. Assemble disc gangs (#9) to main frame (#7) with 5/8" u-bolts (#14) and hex flange locknuts (#13). See **"Disc Gang Lateral Adjustment"** on page 17 for proper spacing.
6. Tighten hex flange locknuts (#13) to the correct torque.
7. Install plastic end caps (#15) in swing arms (#6).

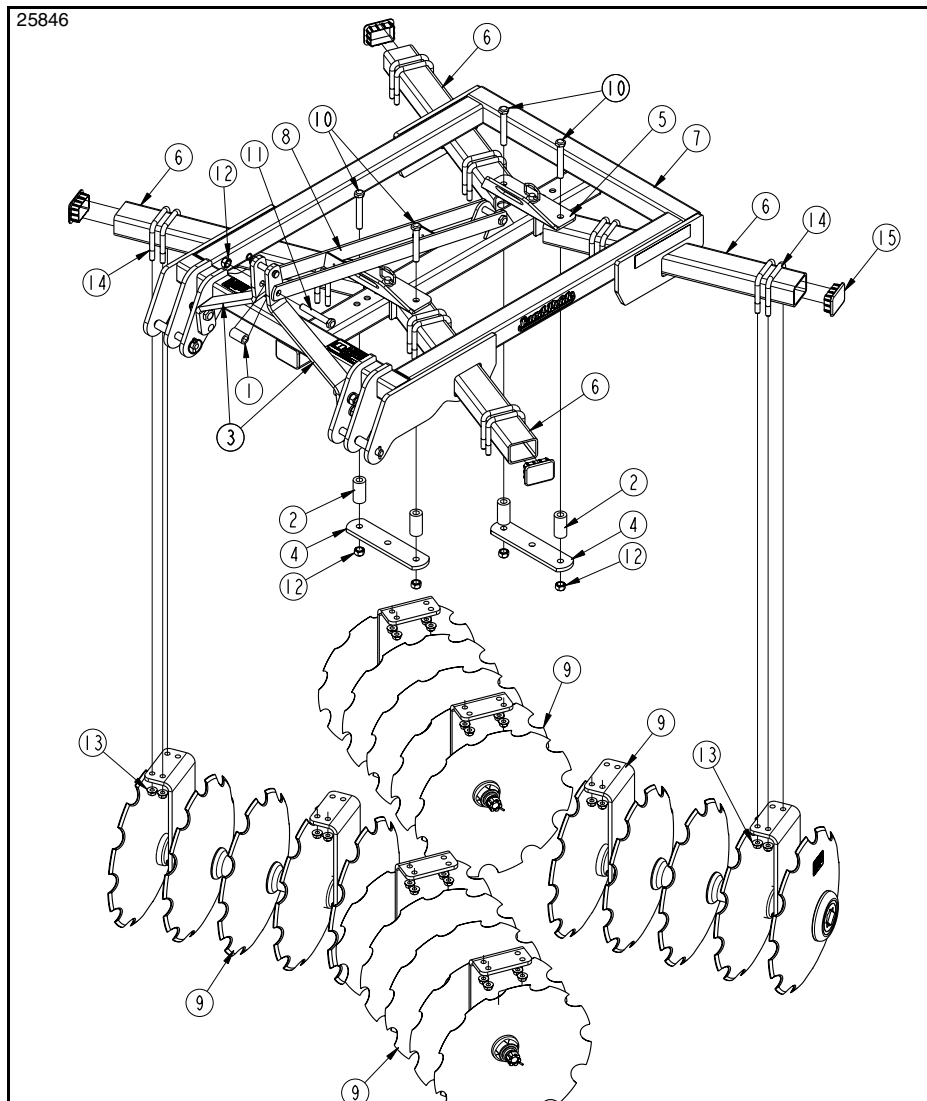

Dealer Assembly (DH2572 Shown)

Figure 1-2

### Optional Equipment

#### Scrapers

#### DH15 & DH25 Series Only

Refer to Figure 1-3:

Install Scraper Assemblies (#1) and (#2) using instruction manual No. 322-042M included with scraper kit.

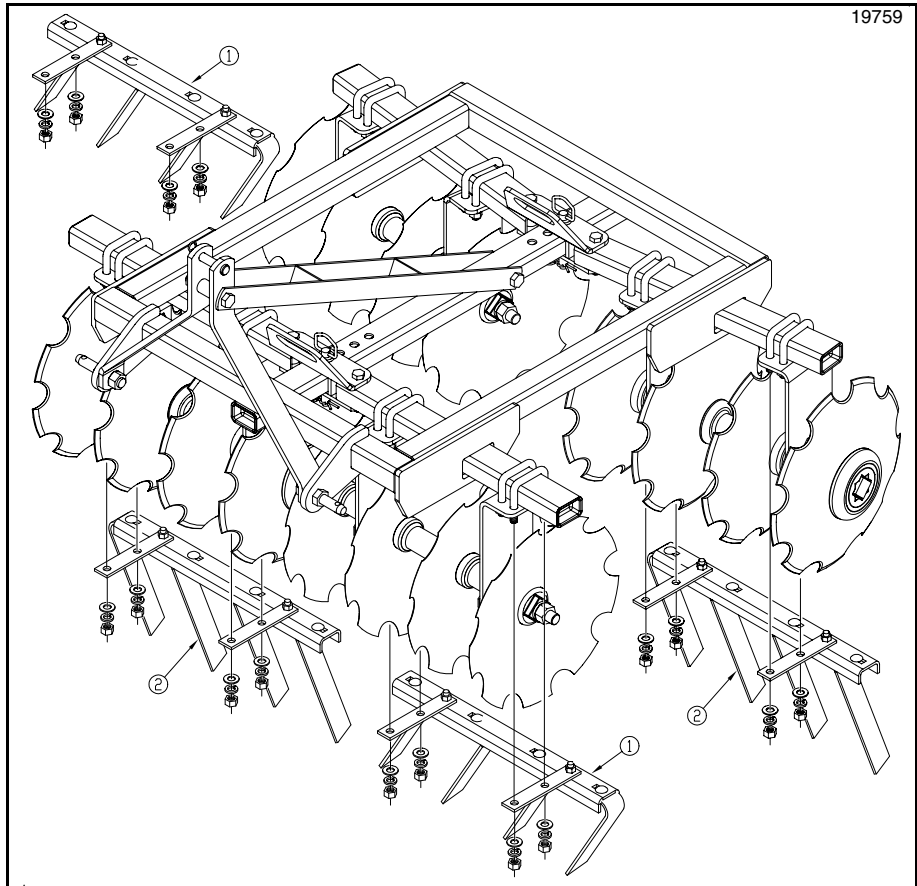

**Scrapers Assembly**  
Figure 1-3

#### Center Sweep

#### DH15 & DH25 Series Only

Refer to Figure 1-4:

Assemble Center Sweep to the center tube of the Disc Harrow Frame.

1. Clamp sweep arm (#8) to center frame with spring bracket (#1), two 5/8"-11 u-bolts (#6), and 5/8"-11 flange locknuts (#4).
2. Tighten hex flange locknuts (#4) to the correct torque.
3. Attach 9" cultivator sweep (#7) to sweep arm (#8) with 7/16"-14 GR5 plow bolts (#2), lock washer (#5), and 7/16"-14 hex nuts (#3).
4. Tighten 7/16" hex nuts to the correct torque.

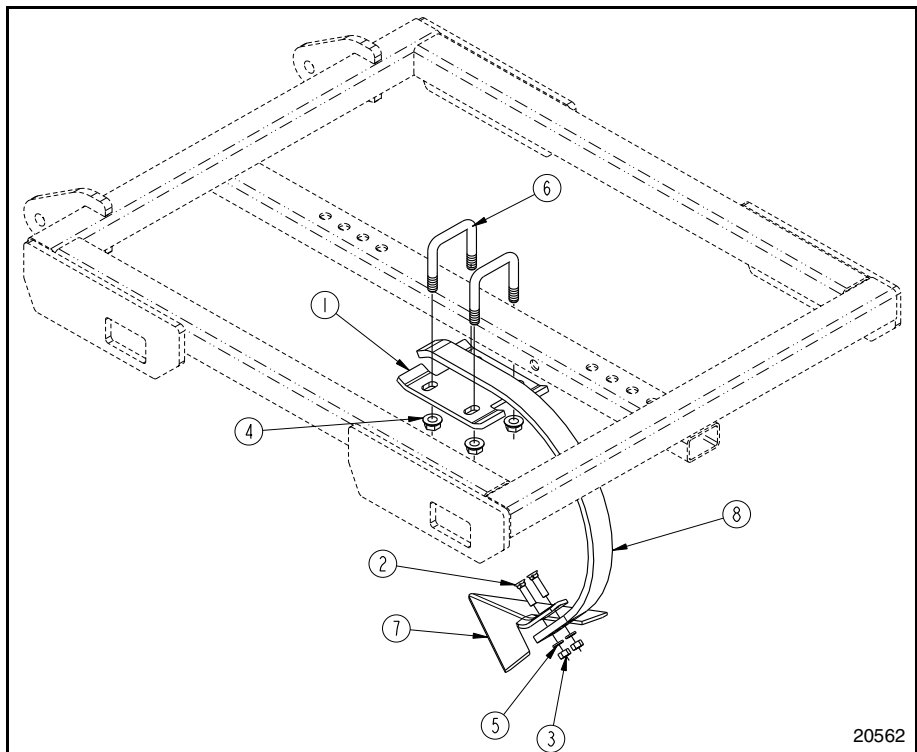

**Center Sweep Assembly**  
Figure 1-4



## Section 1: Assembly & Set-Up

### Tractor Hook-Up

#### DANGER

To avoid serious injury or death:

A crushing hazard exists while hooking-up and unhooking the implement. Keep people and animals away while backing-up to the implement or pulling away from the implement. Do not operate hydraulic controls while a person or animal is directly behind the power machine or near the implement.

**NOTE:** Land Pride's Quick Hitch can be attached to the tractor to provide quick and easy 3-point hook-up and detachment. See your nearest Land Pride dealer to purchase a Quick-Hitch.

#### Refer to Figure 1-5:

1. Check tractor draw bar to make certain it will not interfere with raising and lowering the Disc Harrow. Move draw bar ahead or remove if required. Draw bar should also be rechecked for clearance when raising and lowering the unit for the first time.
2. Align lower link arms of tractor to hitch pins (#1) on Disc Harrow. Insert lower hitch pins into hitch holes n lower 3-point lift arms and secure in place with linchpins (#2) (supplied by customer).
3. Attach tractor top center link to upper hitch of Disc Harrow with hitch pin (#3) and secure with hairpin cotter (#4).
4. Use lower bushing "A" when using a Cat. 1 Quick Hitch for tractor hook-up.

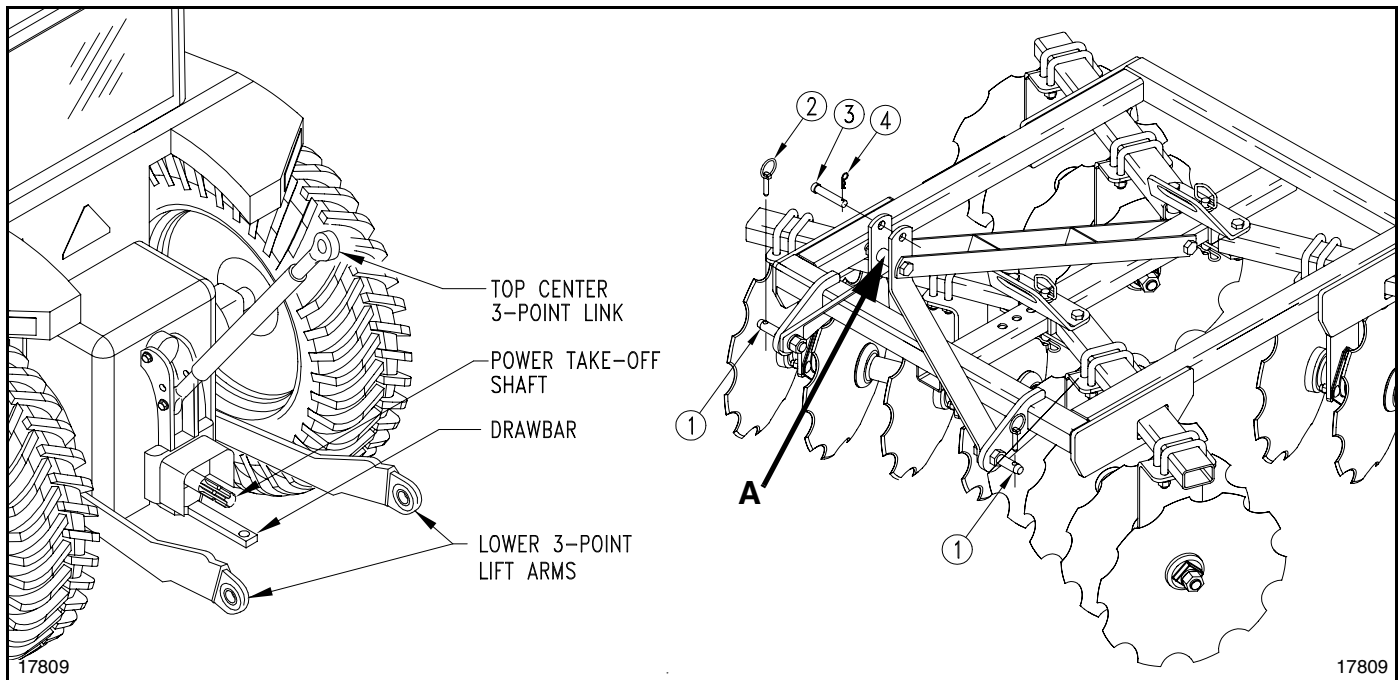

Tractor Hook-Up  
Figure 1-5



## Section 2: Operating Instructions

### Operator's Responsibilities

Hazard control and accident prevention are dependent upon the awareness, concern, prudence, and proper training involved in the operation, transport, storage, and maintenance of the Disc Harrow. Therefore, it is absolutely essential that no one operates the harrow unless they are age 16 or older and have read, fully understood, and are totally familiar with the Operator's Manual. Make sure the operator has paid particular attention to:

- **Important Safety Information**, page 1
- **Section 1: Assembly & Set-Up**, page 10
- **Section 2: Operating Instructions**, page 14
- **Section 3: Adjustments**, page 16
- **Section 5: Maintenance**, page 20

Perform the following inspections before using your Disc Harrow.

#### Operating Checklist

✓	Check	Ref.
✓	Read " <b>Important Safety Information</b> "	1
	Read all of the tractor hook-up and preparation instructions.	13
	Read " <b>Operating Instructions</b> "	14
	Check harrow initially and periodically for loose bolts & pins. Pay special attention to disc gang hanger bolts and axle nuts. Refer to Torque values Chart for torque values.	29

### DANGER

*To avoid serious injury or death:*

*Do not allow anyone near the tractor or implement while operating. Stop operation if bystanders are too close. They can be hit by flying projectiles, become entangled in the equipment, or ran over.*

### WARNING

*To avoid serious injury or death:*

- *Allow only persons to operate this implement who have fully read and comprehended this manual, who have been properly trained in the safe operation of this implement, and who are age 16 or older. Serious injury or death can result from the inability to read, understand, and follow instructions provided in this manual.*
- *Never carry riders on the implement or tractor. Riders can obstruct the operator's view, interfere with controls, be pinched by moving components, become entangled in rotating components, struck by objects, thrown about, fall off and be run over, etc.*
- *Do not use implement to lift objects; to pull objects such as fence posts, stumps, etc.; or to push objects. The unit is not designed or guarded for these uses.*

- *Do not alter implement or replace parts on the implement with other brands. Other brands may not fit properly or meet OEM (Original Equipment Manufacturer) specifications. They can weaken the integrity and impair the safety, function, performance, and life of the implement. Replace parts only with genuine OEM parts.*
- *Perform scheduled maintenance. Check for loose hardware, missing parts, broken parts, structural cracks, and excessive wear. Make repairs before putting the implement back into service.*
- *Keep everyone away from the Disc Harrow while raising, lowering, and transporting the implement to protect against falling blade hazard.*
- *Never make contact with underground utilities such as electrical power lines, gas lines, phone lines, etc. They can cause serious injury or death from electrocution, explosion, or fire. Always call 811 (USA) before digging so that they can mark the location of underground services in the area. For contact information, see Dig Safe in the "Important Safety Information" starting on page 1.*

**IMPORTANT:** Make sure all safety labels are in their proper location and in good condition before operation. Follow all directions on the safety labels.

### Transporting

#### WARNING

*To avoid serious injury or death:*

*When traveling on public roads, use LED lights, slow moving vehicle sign, clean reflectors, and other adequate devices to warn operators in other vehicles of your presence. If implement blocks visibility of slow moving vehicle sign, relocate sign so it is visible from the back at all times. Always comply with all federal, state, and local laws.*

1. Lift Disc Harrow as high as possible to make sure it clears the ground in transportation.
2. Never transport with negative or insufficient front tractor weight. Doing so can result in loss of steering control. If needed, add ballast to the tractor. Refer to tractor Operator's Manual for recommendations.
3. When traveling on roadways, transport in such a way that faster moving vehicles may pass you safely.
4. Do not lower unit while transporting on pavement, blacktop or road. Damage to unit and/or road may occur.
5. Select a safe ground travel speed when transporting from one area to another.
6. Be sure to reduce tractor ground speed when turning; and, leave enough clearance so the Disc Harrow does not contact obstacles such as buildings, trees, or fences.
7. When traveling over rough or hilly terrain, shift tractor to a lower gear.



Section 2: Operating Instructions

Field Operation

**WARNING**

To avoid serious injury or death:

Be careful when working with disc blades as the edges are sharp. Wear gloves when working around disc blades. Keep others away.

**IMPORTANT:** The harrow can be damaged if it is not lifted out of the ground before making sharp turns and before backing-up.

**IMPORTANT:** do not cross straight across steep ditches and banks. Damage to the disc and/or tractor may occur while crossing straight across.

1. After initial adjustments have been made with tractor hooked to the Disc Harrow, you are ready to start discing.
2. Lower Disc Harrow to the ground and start moving forward. Your travel speed will be determined by soil conditions. You may find that you will want to change the disc angle to do the job right. Refer to “**Disc Angling**” on page 16 for detailed instructions.
3. Always lift unit out of ground when turning.
4. Do not disc in reverse (traveling backwards). The Disc Harrow is designed for working soil while traveling forward only. Damage to the harrow may occur. Recommended procedure for working corners or other tight places is:
  - a. Lift unit up.
  - b. Back unit into the corner or other tight areas.
  - c. Lower unit down and proceed forward with disc in the ground.
5. **Refer to Figure 2-1:** Always cross steep ditches and banks on the diagonal! Never cross straight across! Damage to the disc and/or tractor may occur while crossing straight across.

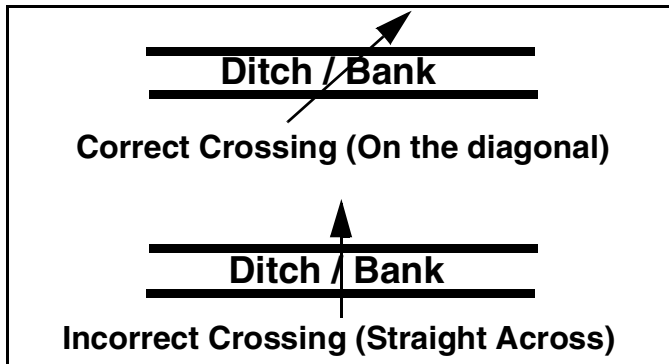

Figure 2-1

General Operating Instructions

Before putting your Land Pride Disc Harrow into service you must thoroughly review the Operator’s Manual. Once you have read the Operator’s Manual and properly mounted your Land Pride Disc Harrow on your tractor, you should be ready to head for the work site. You should have already removed any sizable tree limbs, rocks, or debris from this area. Do not attempt to disc wet or mucky soil and all areas should be well drained and capable of being walked on without having the soil stick to your shoes.

Discing action will commence as soon as the unit touches the ground and tractor begins to move forward. Your travel speed forward will be determined by soil conditions and available tractor horsepower. Never try to disc in reverse and when you reach the end of a pass, pick the unit up before turning. Trying to turn sharply with the unit in the ground will cause extreme side loading on the discs and may cause damage. Making disc gang adjustments is relatively easy by raising the disc off of the ground, placing safety blocks under the frame, pulling the locking pin, making the required adjustment, and then reverse the process till you are back in action. The operator’s manual illustrates this process very clearly.

Ground conditions and the finish you require will determine how you position the angles of your front and rear disc gangs. Both of the front and rear disc gangs have four angle adjustment positions. The best ground finish will usually be achieved when the rear gang is set at a slightly lesser angle than the front gang. The more aggressive you set the angle of the gangs, the more aggressive the cutting action in the soil profile will be. The more aggressive the cutting action is, the more horsepower will be required to pull your unit. Achieving the desired effect may require a little experimentation in your given conditions. If the soil is building up on or sticking to your discs then the soil is too wet and discing operations should be discontinued until the ground is dry and more workable.

Once you are finished using your disc, park it on a dry and level surface, clean it, and make it ready for the next use. With a little practice you will be able to achieve excellent results from your Land Pride Disc Harrow. See “**Features and Benefits**” section or “**Product Specifications**” for additional information and performance enhancing options.

## Section 3: Adjustments

### Disc Angling

Refer to Figure 3-1:

#### WARNING

To avoid serious injury or death:

- Always shut tractor down using “Tractor Shutdown Procedure” provided in this manual before servicing, adjusting, cleaning, or maintaining this implement.
- Properly block and secure disc in the raised position prior to changing gang angles, gang position, disc replacement or during maintenance. Keep feet out from under the disc blades during adjustments or maintenance.
- Be careful when working with disc blades as the edges are sharp. Wear gloves when working around disc blades. Keep others away.

**NOTE:** The more angle you have on the disc, the more aggressive the cut will be, and the more horsepower will be required to pull your unit.

**NOTE:** For a better ground finish, angle the rear gangs at a lesser angle than the front gangs.

The front discs on all series have four angle positions: (0, 7, 14, and 21 degrees.)

The rear discs on DH10 and DH15 Series have four angle positions: (0, 7, 14, and 21 degrees.)

The rear discs on DH25 Series have three angle positions: (7, 14, and 21 degrees.)

The Disc Harrow is designed with handles (#2) to make disc gang angle adjustments easy. Adjust disc gangs as follows:

- **DH10 Series:** Remove hitch pin (#1). Slide handle (#2) to desired position and replace hitch pin.
- **DH15 & DH25 Series:** Remove hitch pin (#1) and hair pin cotter (#3). Slide handle (#2) to desired position and replace hitch pin and hair pin cotter.

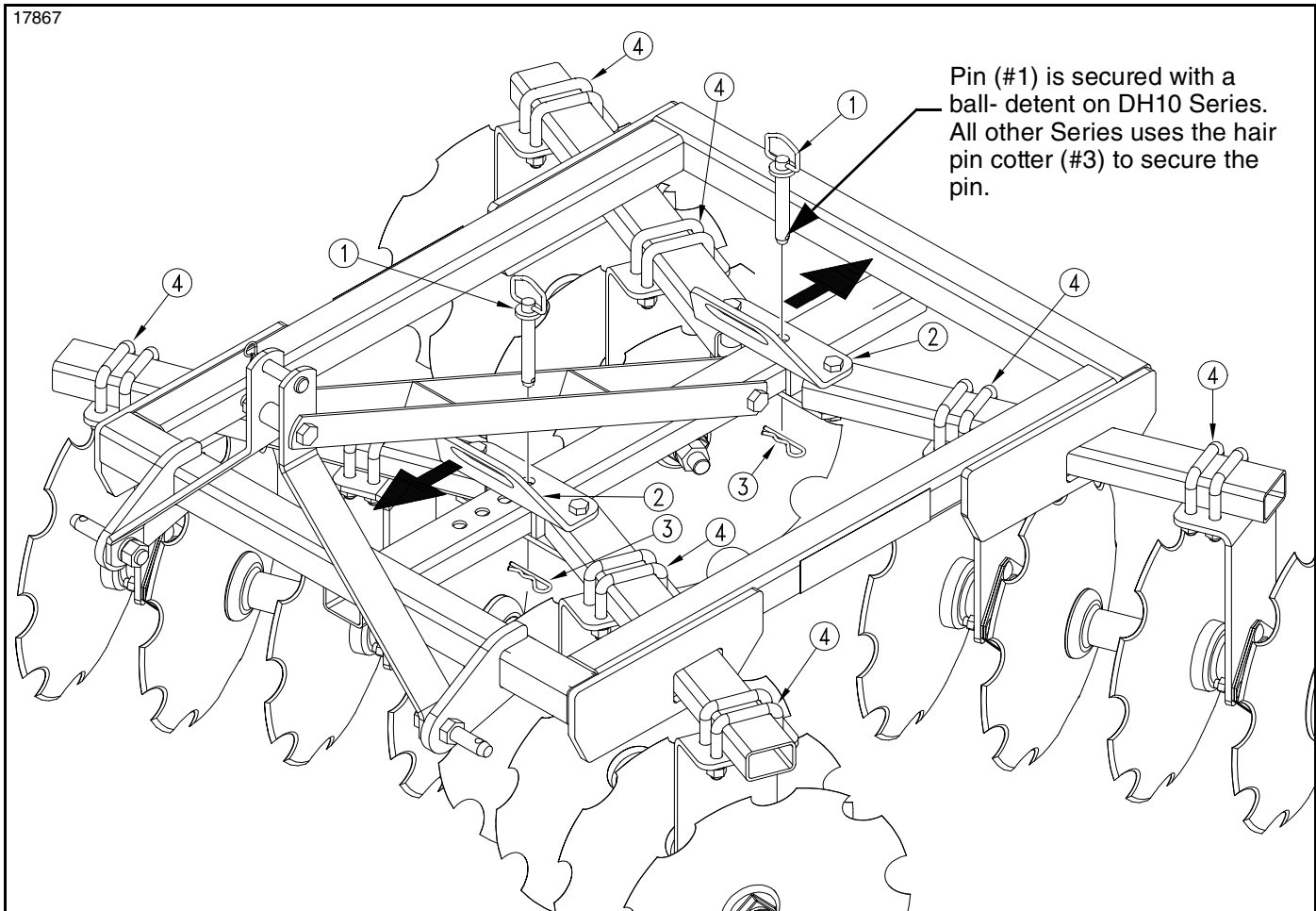

**Disc Adjustments**  
Figure 3-1

Section 3: Adjustments

### Disc Gang Lateral Adjustment

Refer to Figure 3-2:

Additional adjustments can be made by loosening u-bolts (#1) and sliding disc gangs in or out to desired position.

**NOTE:** The rear discs should be centered between the front discs for optimum performance.

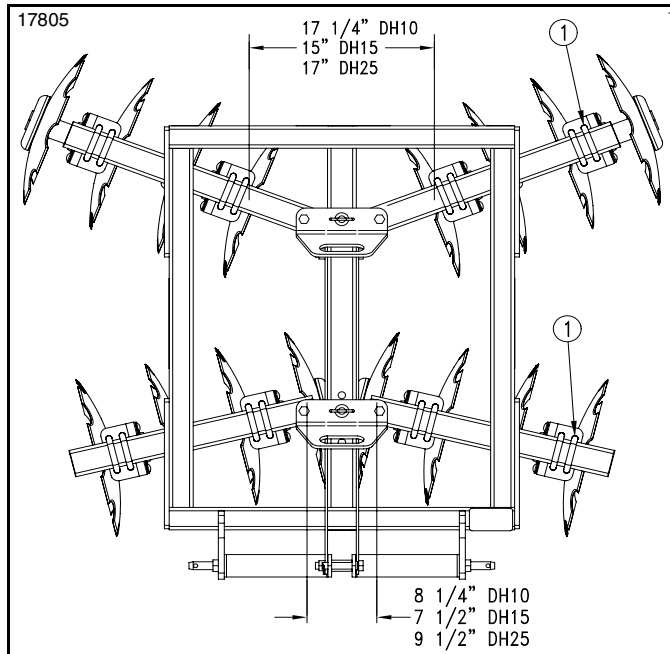

Disc Adjustments  
Figure 3-2

#### Front Disc Gangs on DH10 Series

The recommended position for the front disc gangs (at ground contact point) is 8 1/4" between inside gang disc blades and equally spaced on either side of center frame tube. Tighten u-bolts after adjustment.

#### Front Disc Gangs on DH15 Series

The recommended position for the front disc gangs (at ground contact point) is 7 1/2" between inside gang disc blades and equally spaced on either side of center frame tube. Tighten u-bolts after adjustment.

#### Front Disc Gangs on DH25 Series

The recommended position for the front disc gangs (at ground contact point) is 9 1/2" between inside gang disc blades and equally spaced on either side of center frame tube. Tighten u-bolts after adjustment.

#### Rear Disc Gangs on DH10 Series

The recommended position for the rear disc gangs (at ground contact point) is 17 1/4" between inside disc blades and equally spaced on either side of center frame tube. Tighten u-bolts after adjustment.

#### Rear Disc Gangs on DH15 Series

The recommended position for the rear disc gangs (at ground contact point) is 15" between inside disc blades and equally spaced on either side of center frame tube. Tighten u-bolts after adjustment.

#### Rear Disc Gangs on DH25 Series

The recommended position for the rear disc gangs (at ground contact point) is 17" between inside disc blades and equally spaced on either side of center frame tube. Tighten u-bolts after adjustment.

#### Disc Leveling Front To Rear

The truest way to level your disc from front to rear is to observe behind the center of the Disc Harrow. In most soil conditions, a slight ridge in the center is actually a level operation. More air pockets will form where soil is thrown against each other, causing a small ridge to form that will disappear after a soaking rain.

1. If unit is leaving a significant ridge in the center, raise disc rear gangs by shortening the center 3-Point link.
2. If unit is leaving a furrow (valley) in the center, lower rear disc gangs by lengthening the center 3-Point link.
3. See also Section 8: Troubleshooting for helpful solutions to leveling the Disc Harrow.

#### Disc Blade Replacement

Refer to Figure 3-3:

When replacing notched disc blades, assemble disc blades in a spiral pattern.

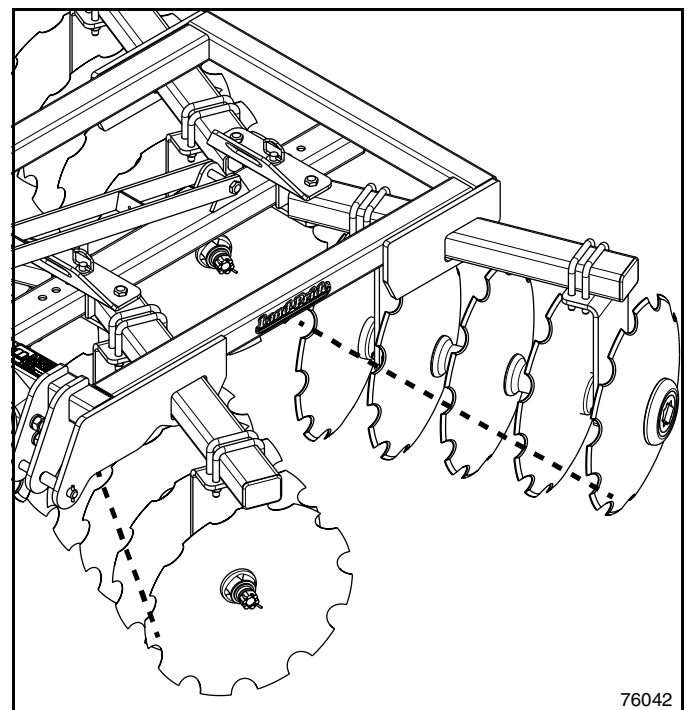

Disc Replacement (Spiral)  
Figure 3-3



Section 4: Accessories

**Electric Spin Spreader**

**Refer to Figure 4-1:**

The Land Pride Electric Spin Spreader is a highly versatile package designed to plant or spread seeds, fertilizer, lime, gypsum, and other soil conditioning amendments at distances ranging from 4 ft. to 20 ft. It can also be used in the off-season to spread sand or salt for winter icing or slick snow conditions.

The unit has a 12 Volt remote tether control that can be operated right from the driver seat to turn the spreader on or off or to set the seed-gate opening to different application rates.

The Spin Spreader has applications in overseeding of pastures, grassy runways, open areas, roadsides, medians, wild game food plots, hunting clubs, hunting resorts, ranches, farms, game preserves, landscaping, and hobby farming. It also works very well in gardens and nurseries to incorporate fertilizer and pelletized gypsum or lime as soil amendments.

Accessories are available for mounting the spreader to a 2" receiver hitch on a utility vehicle or to a Land Pride Disc Harrow. A rear hitch can be attached to the Spin Spreader mounting bracket for the Disc Harrow. The Disc Harrow and Seed Bed Roller can then be hitched to the rear hitch. See "Complete One Pass Seeding Application" on page 19.

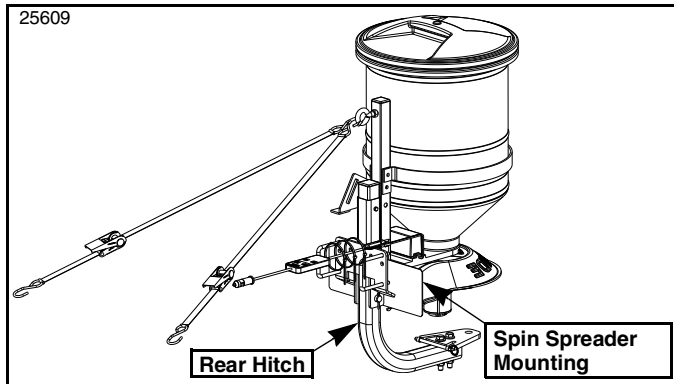

**Electric Spin Spreader, Mounting Bracket & Rear Hitch**  
Figure 4-1

**Drag Harrow**

**Refer to Figure 4-2:**

The Land Pride Drag Harrows are designed for various types of seedbed and ground preparations. They can be used to smooth out freshly cultivated soil, work seed and fertilizer into freshly cultivated soil or into turf and pasture grass, fluff and level arenas, aerate soil for faster dry-downtime, dethatch and aerate lawns and pastures, break up aeration cores on turf surfaces, and groom snow-packed ski resorts.

The Drag Harrow can also be used in tandem with Land Pride's Disc Harrow, Electric Spin Spreader, and Seed Bed Roller to provide a highly efficient and complete seeding application in one pass. See "Complete One Pass Seeding Application" on page 19.

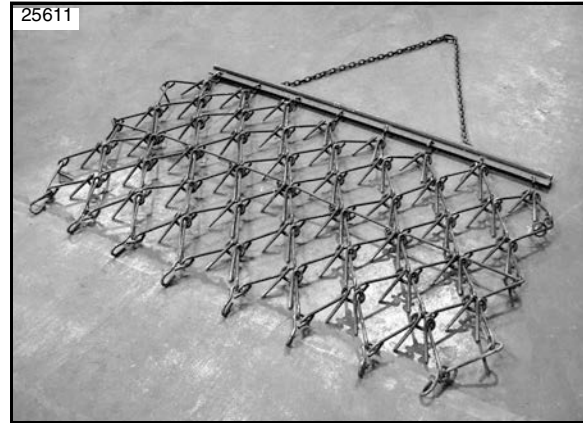

**Drag Harrow (6' x 4' Shown)**  
Figure 4-2

**Land Pride Drag Harrow Models**

Model DRG04	.....	4 ft. wide x 4 ft. long
Model DRG06	.....	6 ft. wide x 4 ft. long
Model DRG08	.....	8 ft. wide x 4 ft. long

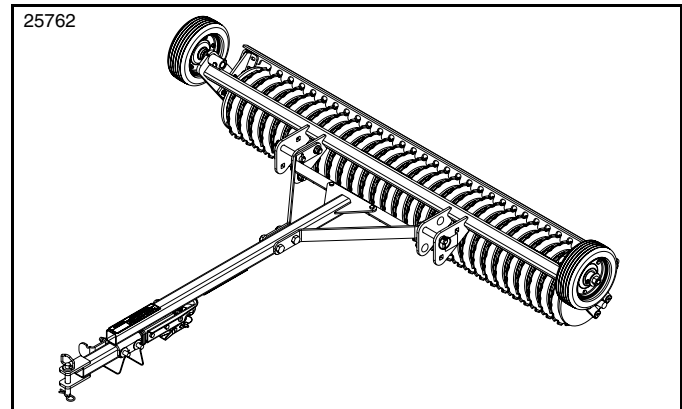

**SBR72 Set-up for Pull Type Hook-Up**  
Figure 4-3

**Seed Bed Roller**

**Refer to Figure 4-3:**

The Land Pride SBR72 Three-point hitch or pull type Seed Bed Roller has uses and applications in landscaping, sports field maintenance, pasture maintenance, professional turf care, general seeding, and overseeding applications around home sites, construction sites, horse paddocks, nurseries, sod farms, and small farm or ranch operations. The SBR72 will break up smaller clumps and dirt clods, while pressing applied seed into firm contact with the soil profile for greatly improved germination rates. The notched profile of the roller also develops a pattern of uniformly spaced mini-furrows that tend to hold seed and fertilizer in place. These small furrows also retain essential moisture, and resist erosion from the wind and runoff from applied irrigation or rain. It can be pulled behind the Electric Spin Spreader or behind any machine equipped with a drawbar or receiver hitch. The hitch on the tongue can be set-up as a clevis hitch or turned around for a ball hitch.

Section 4: Accessories

**Refer to Figure 4-4:**

Remove tongue and rotate remaining A-frame hitch up 90 degrees, and it becomes a 3-Point mounted Seed Bed Roller.

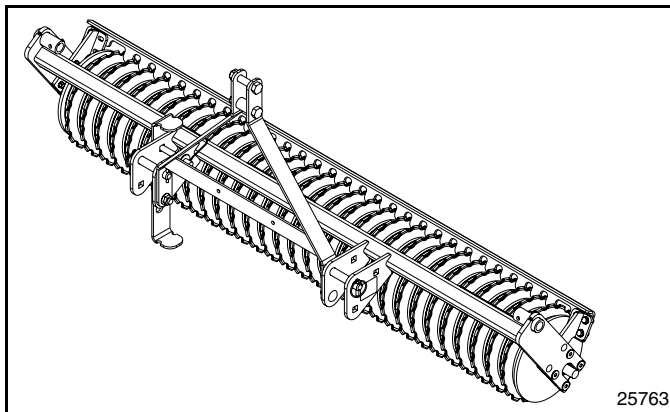

**SBR72 Set-up for 3-Point Hook-Up**  
Figure 4-4

**Complete One Pass Seeding Application**

**Refer to Figure 4-5:**

Land Prides offers a Seeder/Overseeder component system for one-pass ground cultivation and seed to soil integration for applications on previously tilled soil, existing pasture ground, large grassy areas, reclamation sites, and wild game food plots. This system is comprised of a Land Pride DH10, DH15, or DH25 Series Disc Harrow, rear mounted Disc Harrow with special hitch kit, trailing DRG04, DRG06, or DRG08 Disc Harrow, and trailing pull-type SBR72 Seed Bed Roller.

See your nearest Land Pride dealer for more information or visit our web site at [www.landpride.com](http://www.landpride.com).

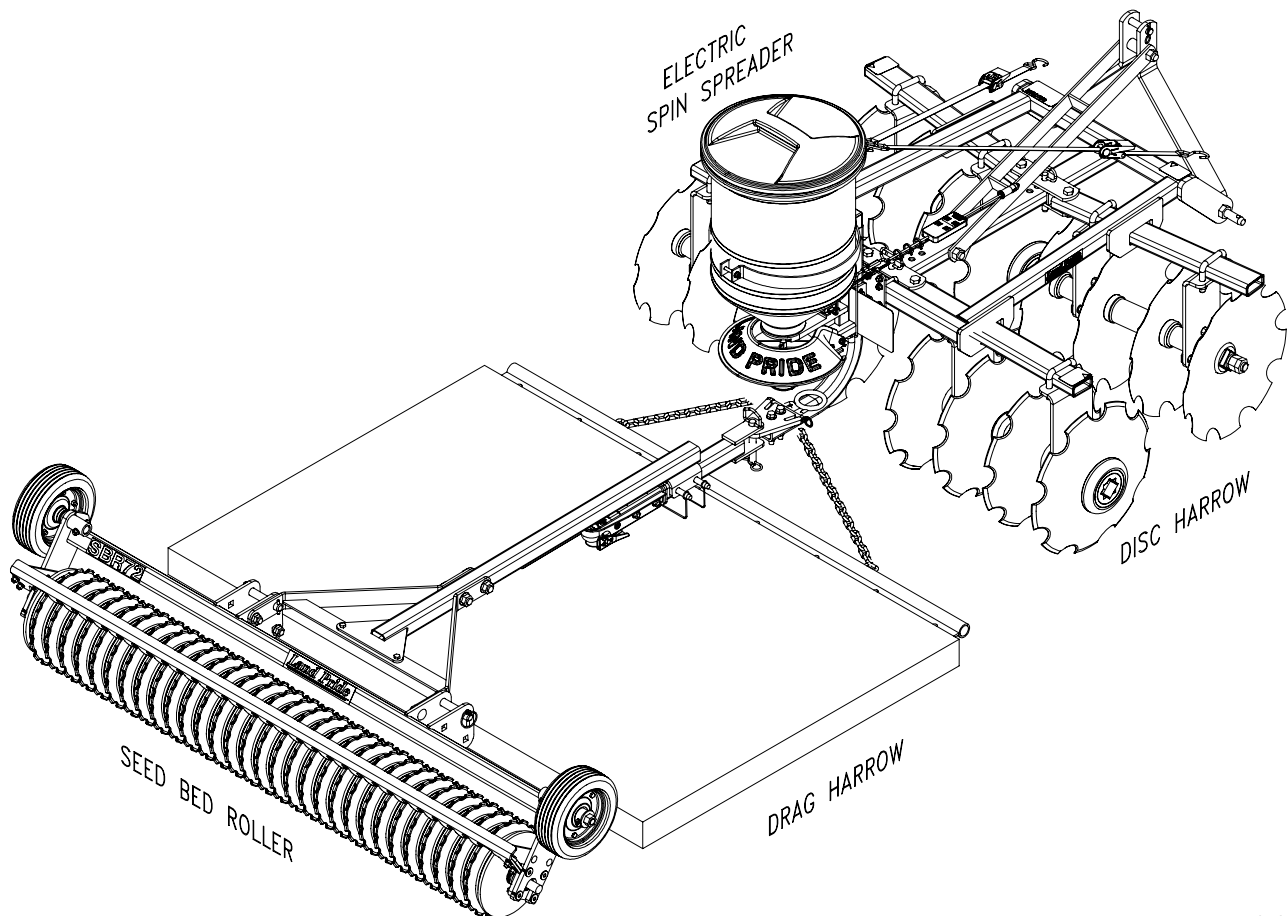

**Complete One Pass Seeding Application**  
Figure 4-5

25802



## Section 5: Maintenance

### General Maintenance Information

Proper servicing and adjustments are key to the long life of any implement. With careful inspection and routine maintenance, you can avoid costly downtime and repair.

Check all bolts after the first initial 5 hours of field operation to be sure they are tight. Torque all nuts to the torque values listed in the “**Torque Value Chart**” on page 29.

Replace any worn, damaged, or illegible safety labels by obtaining new labels from your Land Pride dealer.

#### **DANGER**

*To avoid serious injury or death:*

*Always secure equipment with solid, non-concrete supports before working under it. Never go under equipment supported by concrete blocks or hydraulics. Concrete can break, hydraulic lines can burst, and/or hydraulic controls can be actuated even when power to hydraulics is off.*

#### **WARNING**

*To avoid serious injury or death:*

*Do not alter implement or replace parts on the implement with other brands. Other brands may not fit properly or meet OEM (Original Equipment Manufacturer) specifications. They can weaken the integrity and impair the safety, function, performance, and life of the implement. Replace parts only with genuine OEM parts.*

**IMPORTANT:** Refer to Figure 5-1. Torque disc gang axle nuts to 250 ft. lbs. after the first initial 5 hours of operation. Not tightening axle nuts may result in the nut becoming loose or lost resulting in possible damage to the axle and/or disc gang.

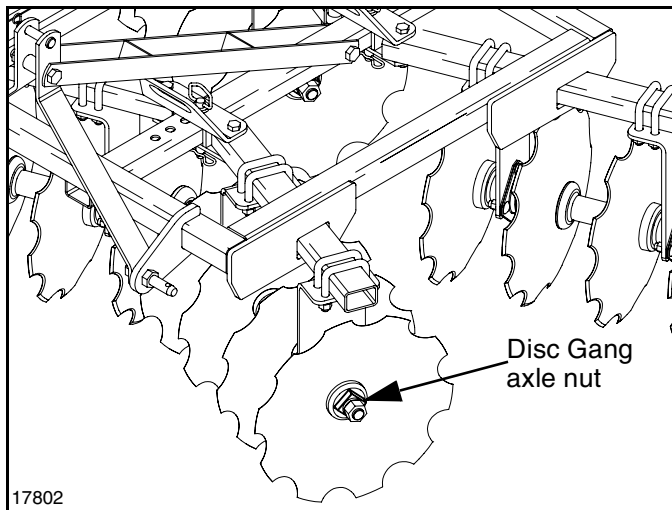

**Disc Gang Axle Nut Location**  
**Figure 5-1**

### Daily Operational Checks

1. Clean unit of dirt and trash to minimize rusting and wear.
2. Visually inspect all nuts for tightness. Torque loose nuts to the torque value listed in the “**Torque Value Chart**” on page 29.
3. Inspect all bearings for wear. Replace any worn out bearings.
4. Replace any decals that are worn or damaged.

### Lubrication

Ensure the flange bearings are properly lubricated ever 25 hours of use. Refer to “**Lubrication Points**” on page 21.

### Long-Term Storage

Clean, inspect, service, and make necessary repairs to the implement when storing it for long periods and at the end of the season. This will help to ensure the unit is ready for field use the next time you hook-up to it.

1. Clean off any dirt and grease that may have accumulated on the Disc Harrow and moving parts. Scrape off compacted dirt and then wash surface thoroughly with a garden hose.
2. Inspect all nuts for tightness. Torque loose nuts to the torque value listed in the “**Torque Value Chart**” on page 29.
3. Inspect all bearings for wear. Replace any worn out bearings.
4. Clean dirt, oil, and grease from areas where paint has been worn, chipped, or scratched. Prime bare metal surfaces after cleaning and repaint to prevent rust. Ask your dealer for Land Pride aerosol touch-up paint. Paint is also available in touch-up bottles with brush, quarts, and gallon sizes by adding TU, QT, or GL to the end of the aerosol part number.

#### Land Pride Touch-up Paint





Part No.	Part Description
821-011C	PAINT LP BEIGE SPRAY CAN
821-066C	PAINT ORANGE SPRAY CAN
821-070C	PAINT GP GLOSS BLACK SPRAY CAN

5. Replace all damaged, missing, and illegible decals.
6. Spray cutting blades with a rust inhibitor or paint to prevent rust.
7. Store harrow on a level surface in a clean, dry place. Inside storage will reduce maintenance and make for a longer harrow life.





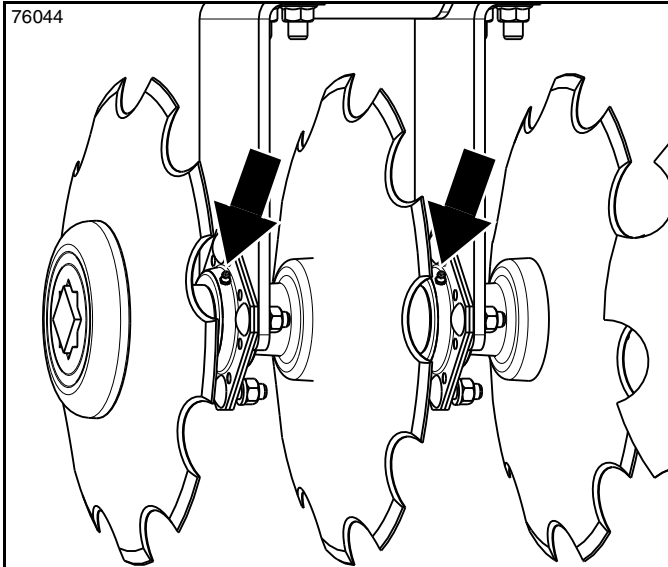

Lubrication Points

<b>Lubrication Legend</b>	 Multi-purpose spray lube	 Multi-purpose grease lube	 Multi-purpose oil lube	 <b>50 Hrs</b>	Intervals in hours at which lubrication is required
				 <b>25 Hours</b>	



	 <b>25 Hours</b>
---	---

**Flange Bearing**

1 grease zerk per flange bearing. Total zerks varies by model size.

Type of Lubrication: Multi-Purpose Grease

Quantity: Add grease until grease begins to emerge.

# Table of Contents

## Section 6: Specifications & Capacities



### DH10, DH15, and DH25 Series

Specifications & Capacities							
	DH1048	DH1060	DH1560	DH1572	DH1590	DH2572	DH2596
<b>3-Point hitch type</b>	Cat. I (Fits Land Pride Quick Hitch)					Cat. I & Cat. II Fits Land Pride Quick Hitch	
<b>Horsepower Rating</b>	Max 40 horsepower (29.8 kw)		Max. 65 horsepower (48.5 kw)			40 to 100 horsepower (29.8 to 74.6 kw)	
<b>Cultivation width</b>	48" (1.22 m)	60" (1.52 m)	60" (1.52 m)	72" (1.83 m)	90" (2.29 m)	72" (1.83 m)	96" (2.44 m)
<b>Height</b>	34 3/4" (88.3 cm)	34 3/4" (88.3 cm)	40 1/8" (101.9 cm)			40 1/4" (102.2 cm)	
<b>Disc blade sizes</b>	16" (40.6 cm)	16" or 18" (40.6 or 45.7 cm)	18" (45.7 cm)			20" or 22" (50.8 or 55.9 cm)	
<b>Length with largest dia. disc blades</b>	50" (1.27 m)	51 3/8" (1.30 m)	57 5/8" (1.46 m)	60 1/8" (1.53 m)	63" (1.60 m)	70 3/4" (1.80 m)	73 1/2" (1.87 m)
<b>Weight</b>	Standard Disc  Larger Disc	421 lbs (191.0 kg)	533 lbs (241.8 kg)	628 lbs (284.9 kg)	714 lbs (323.9 kg)	865 lbs (392.4 kg)	947 lbs (429.6 kg)
		549 lbs (249.0 kg)					1037 lbs (470.4 kg)
<b>Weight load per disc</b>	Standard Disc  Larger Disc	35 lbs (15.9 kg)	33 lbs (15.0 kg)	38 lbs (17.2 kg)	34 lbs (15.4 kg)	36 lbs (16.3 kg)	47 lbs (21.3 kg)
		34 lbs (15.4 kg)					51 lbs (23.1 kg)
<b>No. of disc blades</b>	12	16	16	20	24	20	24
<b>Disc blade types</b>	Notched or smooth					Front - notched Rear - smooth or notched	
<b>Disc blade spacing</b>	7 1/2" (19.1 cm)					7 1/2" (19.1 cm)	
<b>Bearing hanger</b>	3/8" (10 mm) Plate with 5/8" (16 mm) u-bolt		3/8" (10 mm) Plate, 2 each 5/8" (16 mm) u-bolts			1/2" (13 mm) Plate, 2 each 5/8" (16 mm) u-bolts	
<b>Bearing type, 2 per gang</b>	Self aligning, flange bearings with grease zerk						
<b>Disc angle</b>	Front & rear gang: 0, 7, 14, & 21 degrees		Front gang: 0, 7, 14, & 21 degrees with angling adjustment handle Rear Gang: 7, 14 & 21 degrees With angling adjustment handle				
<b>Frame tubes</b>	2" (5.1 cm) square		2 1/2" (6.4 cm) square			3" (7.6 cm) square	
<b>Gang tube</b>	3" x 1 1/2" (7.6 cm x 3.8 cm)		3" x 2" (7.6 cm x 5.1 cm)			4" x 3" (10.2 cm x 7.6 cm)	
<b>Gang axle</b>	1" (2.5 cm) Square high carbon steel					1 1/8" (2.9 cm) Square high carbon steel	
<b>Disc scrapers</b>	Not available		Optional, Adjustable			Optional, Adjustable	
<b>9" Center sweep</b>	Not available		Optional, Removes center ridge				

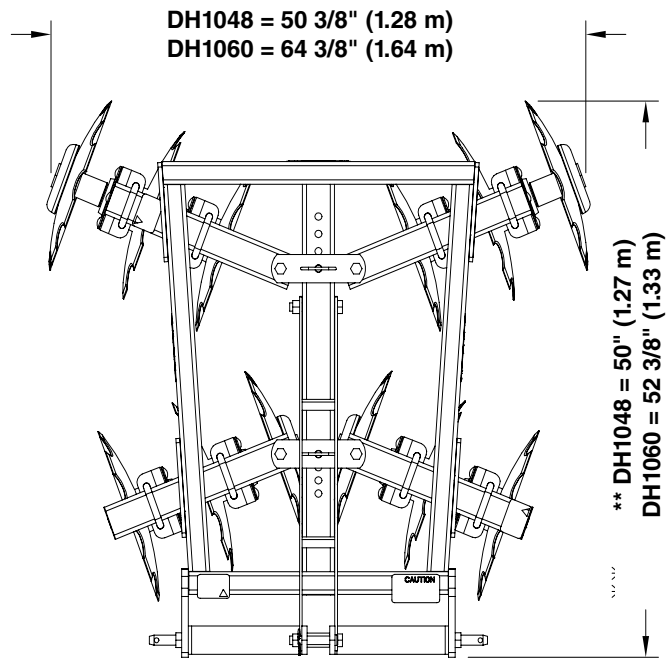

\*\* DIMENSIONS SHOWN WITH 18" (45.7 cm) DIA. DISC  
 SUBTRACT 1" (2.5 cm) FOR 16" (40.6 cm) DIA. DISC

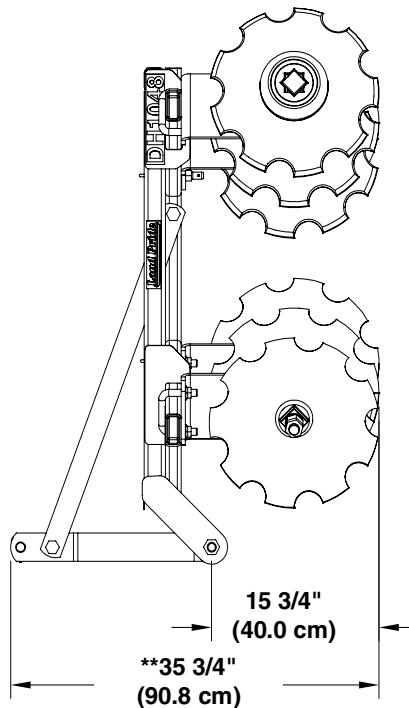

26751

DH10 Series Disc Harrow

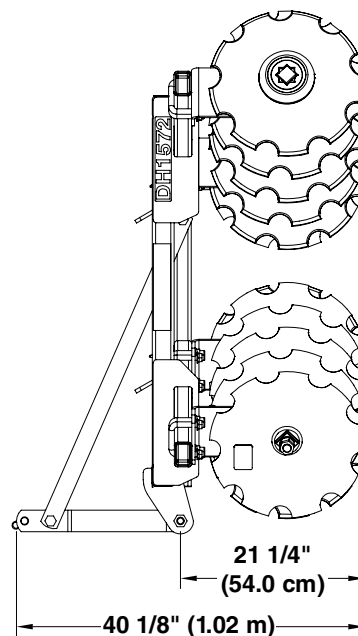
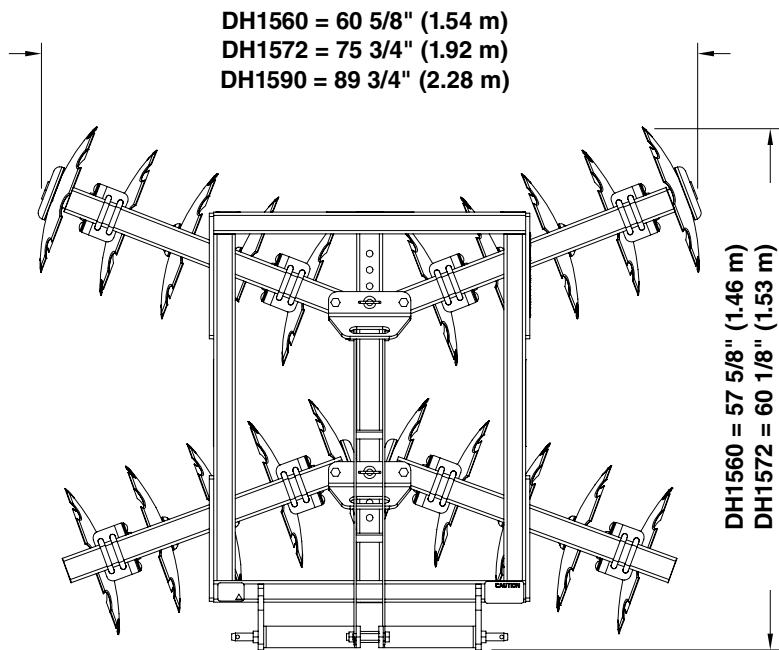

26753

DH15 Series Disc Harrow

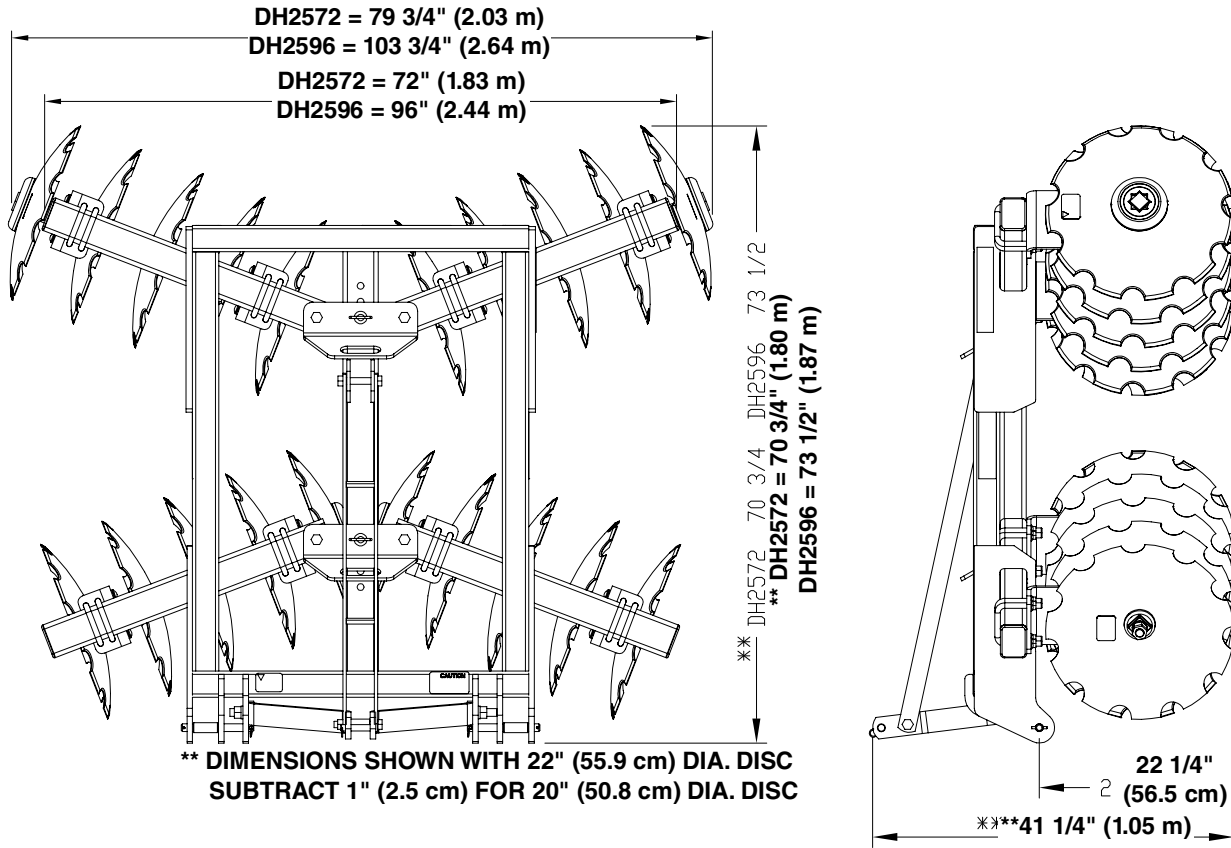

26756

DH25 Series Disc Harrow



### DH10 Series

Features	Benefits
<b>Working widths</b>	48", 60"
<b>Cat. 1 3-Point hitch</b>	Fits Land Pride Quick Hitch for easy one-person hook-up and unhook.
<b>Weight</b>	48" - 412 lbs.; 60" - 533 lbs. Heavy construction helps penetrate ground.
<b>2" Square frame tube</b>	Frame tubing is stronger than angle iron.
<b>4 Adjustable gang angles</b>	Cutting aggressiveness can be adjusted on the front and rear up to 21 degrees.
<b>3" x 1 1/2" Gang tube, 1" Sq. gang axles, high carbon steel</b>	High carbon square axles offer great strength in punishing conditions.
<b>16" or 18" Notched or smooth disc blades</b>	Choose notched blades for more aggressive digging and cutting action, or the smooth blades for light tilling. (16" blades only on 48" width)
<b>3/8" Thick bearing hangers</b>	Heavy-duty hangers resist the high torque from U-bolts and/or keep the discs out of the ground.
<b>3/8" Frame side plates</b>	Offer additional strength and reinforcement to the gang tube.
<b>Self aligning bearings</b>	Self-aligning bearings with grease fitting offer long life while pounding through hard ground.

### DH15 Series

Features	Benefits
<b>Working widths</b>	60", 72" & 90"
<b>Cat. 1 3-Point hitch</b>	Fits Land Pride Quick Hitch for easy one-person hook-up and unhook.
<b>Weight</b>	60" - 629 lbs.; 72" - 714 lbs.; 90" - 865 lbs. Heavy construction helps penetrate ground.
<b>2 1/2" Square frame tube</b>	Frame tubing is stronger than angle iron.
<b>4 Adjustable front gang angles 3 Adjustable rear gang angles</b>	Cutting aggressiveness can be adjusted on the front and rear up to 21 degrees.
<b>Adjustable gang handles</b>	Easy adjustment of gang angles.
<b>3" x 2" Gang tube, 1" Square gang axles, high carbon steel</b>	High carbon square axles offer great strength in punishing conditions.
<b>18" Notched or smooth disc blades</b>	Choose notched blades for more aggressive digging and cutting action, or the smooth blades for light tilling.
<b>3/8" Thick bearing hangers with two 5/8" U-bolts</b>	Heavy-duty hangers resist the high torque from U-bolts and/or keep the discs out of the ground.
<b>1/2" Frame side plates</b>	Offer additional strength and reinforcement to the gang tube.
<b>Self aligning bearings</b>	Self-aligning bearings with grease fitting offer long life while pounding through hard ground.
<b>Optional scrapers</b>	Scrapers will clean the discs off which can plug up and/or keep the discs out of the ground.



### DH25 Series

Features	Benefits
<b>Working widths</b>	72", 96"
<b>Cat. 1 &amp; 2 3-Point hitch</b>	Fits a wide variety of tractors.
<b>Quick Hitch compatible</b>	Fits Land Prides Quick Hitch for easy one-person hook-up and unhook.
<b>Weight</b>	72" = 947 lbs.; 96" = 1143 lbs. Heavy construction helps penetrate ground
<b>3" Square frame tube</b>	Heavy frame can handle 100 horsepower tractors.
<b>Self aligning bearings</b>	Self-aligning bearings with grease fitting offer long life while pounding through hard ground.
<b>4 Adjustable front gang angles 3 Adjustable rear gang angles</b>	Vary the degree of aggressiveness on both front and rear gangs up to 21 degrees.
<b>Gang adjustment handle</b>	Easy adjustment of gang angles.
<b>4" x 3" Gang tube</b>	The gang tube resists twisting due to 4" horizontal width.
<b>1 1/8" Square gang axles</b>	Large axles can resist the high load put on them as the discs roll through the ground.
<b>20" or 22" Notched disc blades</b>	Larger discs will penetrate harder ground.
<b>1/2" Thick bearing hangers</b>	1/2" Thick bearing hangers resist high torque.
<b>Optional scrapers</b>	Scrapers will clean the disc blades off which can plug up and/or keep the discs out of the ground due to mud build-up. Adjustable.



### Troubleshooting Chart

Problem	Cause	Solution
<b>Disc Harrow makes a high center ridge.</b>	Disc blades are moving too much soil to the center.	Tilt Disc Harrow up at the rear by shortening the center 3-Point link. See “Disc Leveling Front To Rear” on page 17.
		Decrease tractor speed.
		Increase spacing between disc gangs by moving all gang hangers on both sides away from the center equal amounts.
<b>Disc Harrow cuts a furrow (valley) in the center.</b>	Disc blades are not moving enough soil to the center.	Tilt Disc Harrow down at the rear by lengthening the center 3-Point link.
		Increase tractor speed.
		Reduce spacing between rear disc gangs by moving all gang hangers on both sides toward the center by equal amounts.
<b>Disc Harrow makes ridges on the out side cuts and furrows just inside the ridges.</b>	Too much soil is thrown out by the front disc gangs.	Check front to rear disc leveling. Raise front disc gangs by lengthening the center 3-Point link.
		Reduce front disc gang angle by one position.
<b>Disc Harrow makes a furrow on the out side cuts and a ridge just inside the furrow.</b>	Rear disc gangs are set too wide and picks up soil beyond where the front gangs throw it out.	Reduce spacing between rear disc gangs by moving all rear gang hangers in toward the center equal amounts.
		Raise front disc gangs by lengthening the center 3-Point link.
<b>Disc Harrow does not pull straight and/or shifts from side to side.</b>	Front disc gangs run deeper than the rear disc gangs.	Tilt Disc Harrow down at the rear by lengthening the center 3-Point link.
	Disc gangs are not centered on the frame.	Center disc gangs on the Disc Harrow.
	Front disc gangs not at the same angle.	Set Front disc gangs at the same angle.
	Rear disc gangs not at the same angle.	Set Rear disc gangs at the same angle.
<b>Disc Harrow leaves a depression in the worked soil behind tractor wheels</b>	Tire slippage, heavy tractor, soft soil conditions.	Add duals, increase tractor speed, increase gang angle and/or increase cutting depth.
		Tilt Disc Harrow down at the rear by lengthening the center 3-Point link.
<b>Disc Harrow won’t settle down and operate smoothly.</b>	Disc gang angles are set too high.	Set disc gang angles at the smallest angle required to do the job. Make sure front disc gangs are set 3 degrees higher than the rear disc gang angles.
<b>Disc Harrow does not penetrate soil properly.</b>	Disc gangs are not set at enough angle.	Increase disc gang angles. Make sure the front disc gangs are set 3 degrees more than the rear disc gangs.
<b>Outside front disc blades and/or gang axle is bending or breaking.</b>	Making sharp turns and crossing ditches with Disc Harrow in the ground.	Raise Disc Harrow out of the ground when making sharp turns and crossing ditches. Do Not cross deep ditches.
	Gang axles become loose	Keep disc gang axle nuts tight. See “ <b>Additional Torque Values</b> ” on page 26.



### Troubleshooting Chart

Problem	Cause	Solution
<b>Disc gang axles keep coming loose or are bending.</b>	Disc components are not sliding on axle giving a false sense of tightness	Check fit-up of all disc components. Make sure they are all tight against one another. Especially check to make sure end washers and disc blades are on correct.
	Foreign objects that become clamped between disc components and fall out through use.	Completely disassembly disc gang components and clean thoroughly before reassembling. Check spacers for uneven edges that will not allow a tight seal between disc blade and spacer.
	Solid obstructions in the soil such as rocks and stumps.	Remove solid obstructions, raise disc up above solid objects or go around. Travel 3 mph or slower over small obstructions.
<b>Bearing problems</b>	Flange bearing lacking proper lubrication.	Lubricate flange bearings.
	Bent gang axle causing bearing to wobble.	Replace gang axle and damaged bearings.
	Foreign objects and/or dirt caught between spacer and disc blades causing bearing to wobble.	Completely disassembly disc gang components and clean thoroughly before reassembling. Replace damaged bearings.
	Abrasive material such as wire rubbing against the bearing and destroying its seals.	Remove abrasive material right away. Replace damaged bearings.
	Contaminated bearings caused by not cleaning the grease zerks before adding grease to the bearings.	Always clean grease zerks before pumping grease into the bearings. Replace damaged bearings.
	Pumping grease into the bearing too fast in cold weather will pop off bearing seals.	Pump grease into the bearings slower especially in cold weather. Replace all damaged bearings.





Section 9: Torque Values Chart

Torque Values Chart for Common Bolt Sizes													
Bolt Size (inches)	Bolt Head Identification						Bolt Size (Metric)	Bolt Head Identification					
	Grade 2		Grade 5		Grade 8			Class 5.8		Class 8.8		Class 10.9	
in-tpi <sup>1</sup>	N · m <sup>2</sup>	ft-lb <sup>3</sup>	N · m	ft-lb	N · m	ft-lb	mm x pitch <sup>4</sup>	N · m	ft-lb	N · m	ft-lb	N · m	ft-lb
1/4" - 20	7.4	5.6	11	8	16	12	M 5 X 0.8	4	3	6	5	9	7
1/4" - 28	8.5	6	13	10	18	14	M 6 X 1	7	5	11	8	15	11
5/16" - 18	15	11	24	17	33	25	M 8 X 1.25	17	12	26	19	36	27
5/16" - 24	17	13	26	19	37	27	M 8 X 1	18	13	28	21	39	29
3/8" - 16	27	20	42	31	59	44	M10 X 1.5	33	24	52	39	72	53
3/8" - 24	31	22	47	35	67	49	M10 X 0.75	39	29	61	45	85	62
7/16" - 14	43	32	67	49	95	70	M12 X 1.75	58	42	91	67	125	93
7/16" - 20	49	36	75	55	105	78	M12 X 1.5	60	44	95	70	130	97
1/2" - 13	66	49	105	76	145	105	M12 X 1	90	66	105	77	145	105
1/2" - 20	75	55	115	85	165	120	M14 X 2	92	68	145	105	200	150
9/16" - 12	95	70	150	110	210	155	M14 X 1.5	99	73	155	115	215	160
9/16" - 18	105	79	165	120	235	170	M16 X 2	145	105	225	165	315	230
5/8" - 11	130	97	205	150	285	210	M16 X 1.5	155	115	240	180	335	245
5/8" - 18	150	110	230	170	325	240	M18 X 2.5	195	145	310	230	405	300
3/4" - 10	235	170	360	265	510	375	M18 X 1.5	220	165	350	260	485	355
3/4" - 16	260	190	405	295	570	420	M20 X 2.5	280	205	440	325	610	450
7/8" - 9	225	165	585	430	820	605	M20 X 1.5	310	230	650	480	900	665
7/8" - 14	250	185	640	475	905	670	M24 X 3	480	355	760	560	1050	780
1" - 8	340	250	875	645	1230	910	M24 X 2	525	390	830	610	1150	845
1" - 12	370	275	955	705	1350	995	M30 X 3.5	960	705	1510	1120	2100	1550
1-1/8" - 7	480	355	1080	795	1750	1290	M30 X 2	1060	785	1680	1240	2320	1710
1-1/8" - 12	540	395	1210	890	1960	1440	M36 X 3.5	1730	1270	2650	1950	3660	2700
1-1/4" - 7	680	500	1520	1120	2460	1820	M36 X 2	1880	1380	2960	2190	4100	3220
1-1/4" - 12	750	555	1680	1240	2730	2010	<sup>1</sup> in-tpi = nominal thread diameter in inches-threads per inch <sup>2</sup> N · m = newton-meters <sup>3</sup> ft-lb= foot pounds <sup>4</sup> mm x pitch = nominal thread diameter in millimeters x thread pitch						
1-3/8" - 6	890	655	1990	1470	3230	2380							
1-3/8" - 12	1010	745	2270	1670	3680	2710							
1-1/2" - 6	1180	870	2640	1950	4290	3160							
1-1/2" - 12	1330	980	2970	2190	4820	3560							
Torque tolerance + 0%, -15% of torquing values. Unless otherwise specified use torque values listed above.													
Additional Torque Values													
Disc Gang Axle Nuts 1"-8 UNC							250 ft. lbs.						

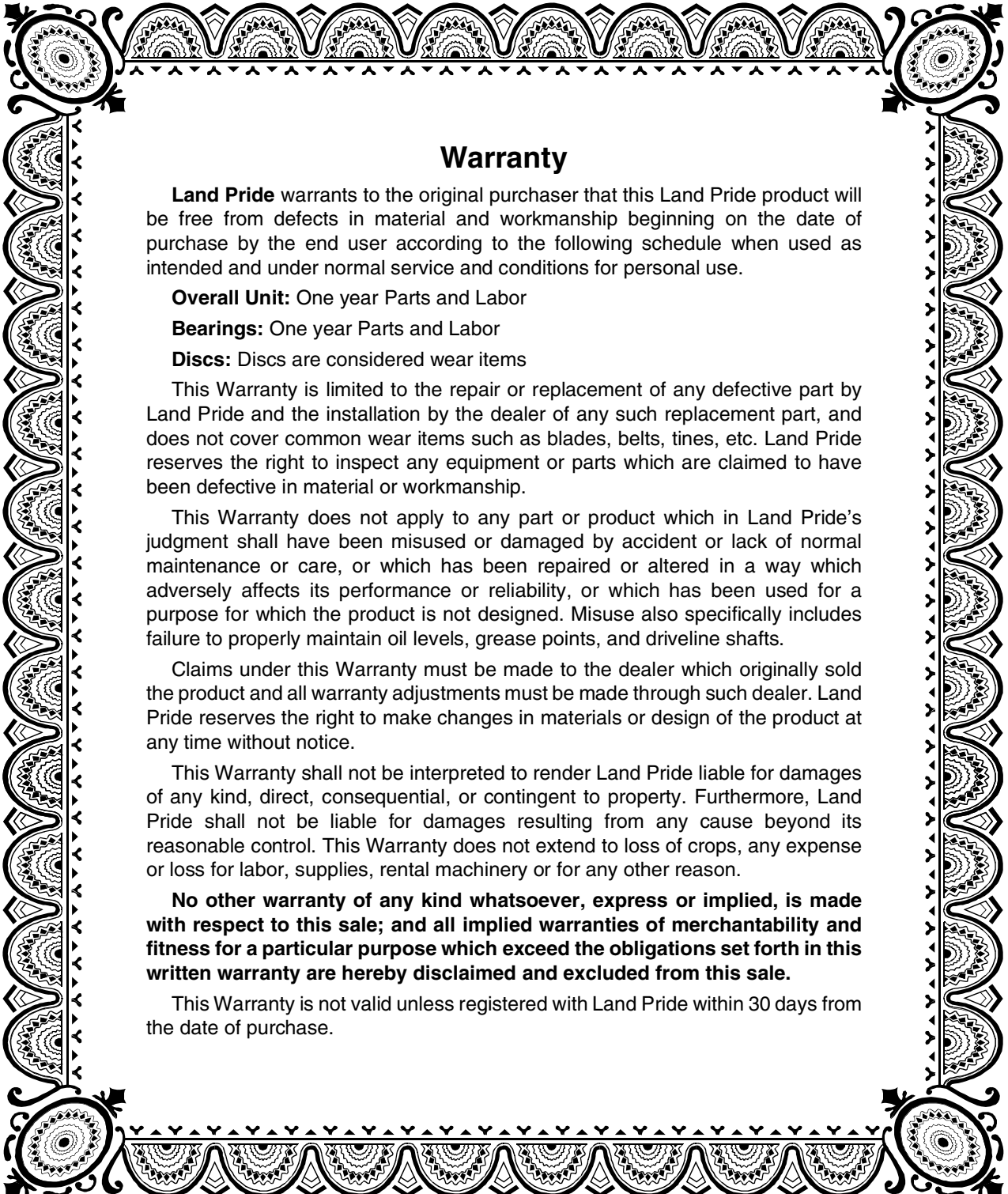

## Warranty

**Land Pride** warrants to the original purchaser that this Land Pride product will be free from defects in material and workmanship beginning on the date of purchase by the end user according to the following schedule when used as intended and under normal service and conditions for personal use.

**Overall Unit:** One year Parts and Labor

**Bearings:** One year Parts and Labor

**Discs:** Discs are considered wear items

This Warranty is limited to the repair or replacement of any defective part by Land Pride and the installation by the dealer of any such replacement part, and does not cover common wear items such as blades, belts, tines, etc. Land Pride reserves the right to inspect any equipment or parts which are claimed to have been defective in material or workmanship.

This Warranty does not apply to any part or product which in Land Pride's judgment shall have been misused or damaged by accident or lack of normal maintenance or care, or which has been repaired or altered in a way which adversely affects its performance or reliability, or which has been used for a purpose for which the product is not designed. Misuse also specifically includes failure to properly maintain oil levels, grease points, and driveline shafts.

Claims under this Warranty must be made to the dealer which originally sold the product and all warranty adjustments must be made through such dealer. Land Pride reserves the right to make changes in materials or design of the product at any time without notice.

This Warranty shall not be interpreted to render Land Pride liable for damages of any kind, direct, consequential, or contingent to property. Furthermore, Land Pride shall not be liable for damages resulting from any cause beyond its reasonable control. This Warranty does not extend to loss of crops, any expense or loss for labor, supplies, rental machinery or for any other reason.

**No other warranty of any kind whatsoever, express or implied, is made with respect to this sale; and all implied warranties of merchantability and fitness for a particular purpose which exceed the obligations set forth in this written warranty are hereby disclaimed and excluded from this sale.**

This Warranty is not valid unless registered with Land Pride within 30 days from the date of purchase.

**IMPORTANT:** The Online Warranty Registration should be completed by the dealer at the time of purchase. This information is necessary to provide you with quality customer service.

Model Number \_\_\_\_\_

Serial Number \_\_\_\_\_



**Section 10: Warranty**

---

This page left blank intentionally.



Corporate Office: P.O. Box 5060  
Salina, Kansas 67402-5060 USA  
[www.landpride.com](http://www.landpride.com)

---